

Product Catalogue

VGK Cantilevered Parapet Bracket

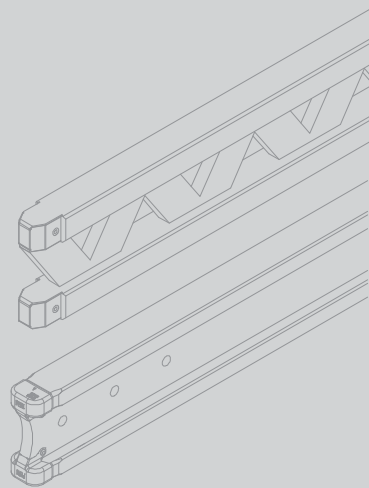

VGK Cantilevered Parapet Bracket

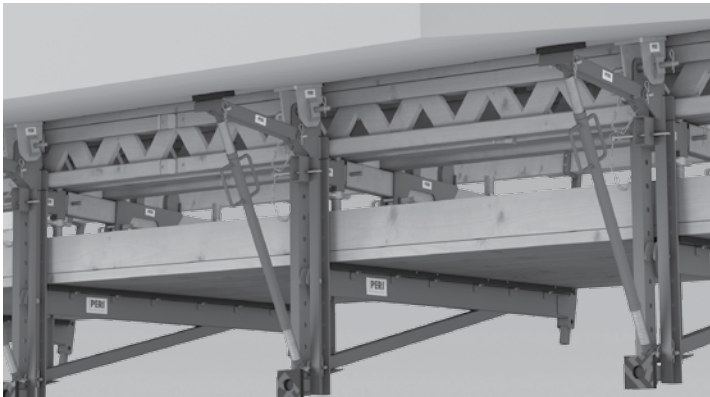

Item no.	Weight kg
124413	4.390

Suspension Head VGK

To attach the Bracket Post VGK 110/139 to the structure.

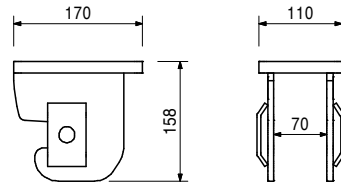
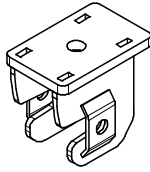

124404	17.300
--------	--------

Bracket Post VGK 110

For connection of the Platform Cantilever Beam VGK 170 and formwork with parapet height up to 60 cm.

Complete with

- 1 pc. 118463 Bolt \varnothing 16 x 90, galv.
- 1 pc. 113012 Pin \varnothing 20 x 260, galv.
- 2 pc. 018060 Cotter Pin 4/1, galv.

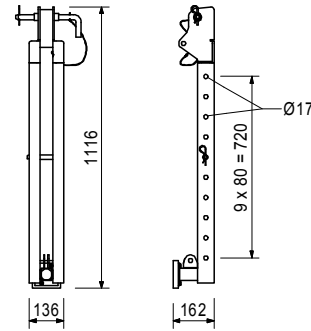

124427	22.000
--------	--------

Bracket Post VGK 139

For connection of the Platform Cantilever Beam VGK 170 and formwork with parapet heights from 60 to 100 cm.

Complete with

- 2 pc. 118463 Bolt \varnothing 16 x 90, galv.
- 1 pc. 113012 Pin \varnothing 20 x 260, galv.
- 3 pc. 018060 Cotter Pin 4/1, galv.

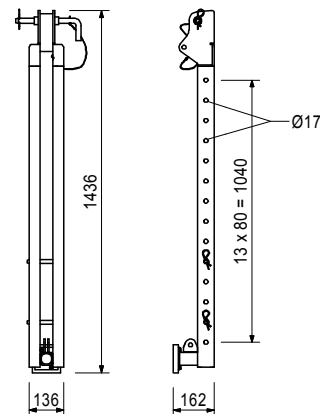
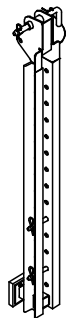

VGK Cantilevered Parapet Bracket



Item no.	Weight kg
057087	3.510
057088	4.200

Kickers AV
Kicker AV 82
Kicker AV 111
 For aligning PERI Formwork Systems.

min. L	max. L
500	820
790	1110

Complete with
 1 pc. 027170 Pin Ø 16 x 42, galv.
 1 pc. 018060 Cotter Pin 4/1, galv.

Note
 Permissible load see PERI Design Tables.

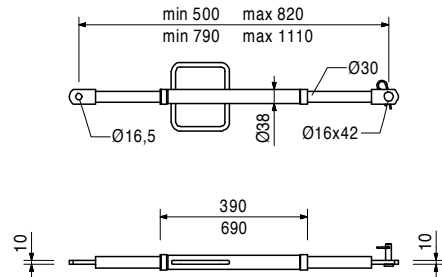
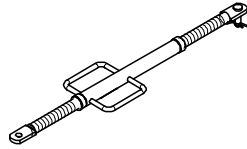

028110	4.850
--------	-------

Kicker AV 140
 Extension length l = 1.08 – 1.40 m.
 For aligning PERI Formwork Systems.

Complete with
 1 pc. 027170 Pin Ø 16 x 42, galv.
 1 pc. 018060 Cotter Pin 4/1, galv.

Note
 Permissible load see PERI Design Tables.

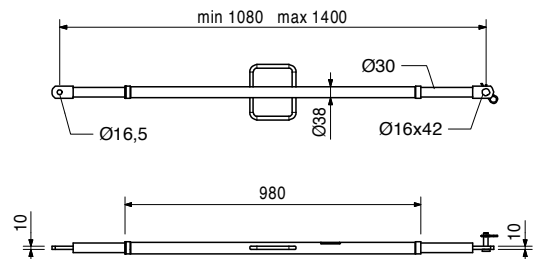
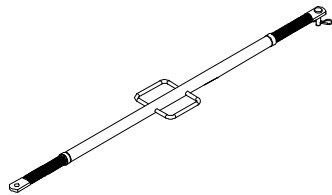

124455	3.050
--------	-------

Bracket Cantilever VGK 50
 For assembly of the bracket unit with Bracket Post VGK 110/139 and Kicker AV 111/140.

Complete with
 2 pc. 118463 Bolt Ø 16 x 90, galv.
 2 pc. 018060 Cotter Pin 4/1, galv.

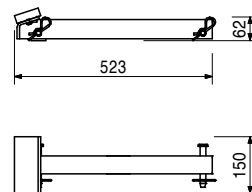
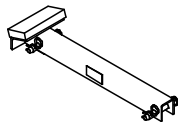

VGK Cantilevered Parapet Bracket



Item no.	Weight kg
124447	21.100

Platform Cantilever Beam VGK 170

For connection to the Bracket Post VGK 110/139 and installation of a fully closed platform planking.

Complete with

1 pc. 118463 Bolt \varnothing 16 x 90, galv.
1 pc. 018060 Cotter Pin 4/1, galv.

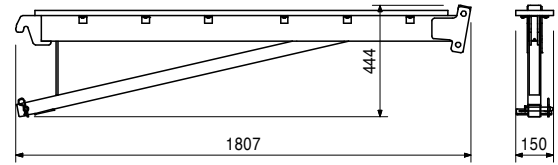
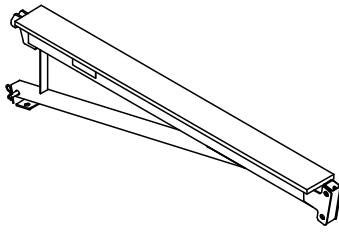

116292	4.720
--------	-------

Guardrail Post HSGP-2

As guardrail for different systems.

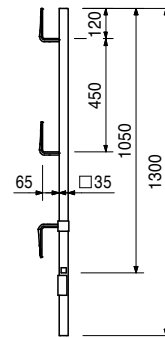

114328	16.600
--------	--------

Guardrail Post RCS/SRU 184

For assembly of the guardrail on the Platform Beam RCS/SRU or Angle Connector RCS/SRU.

Complete with

2 pc. 114727 Bolt ISO 4017 M20 x 100-8.8, galv.
2 pc. 781053 Nut ISO 7040 M20-8, galv.

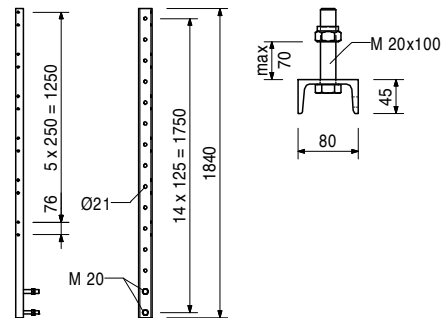

124394	6.640
--------	-------

Formwork Fixing VGK 2

For connection of the Formwork Support VGK 100 to the Bracket Post VGK 110/139.

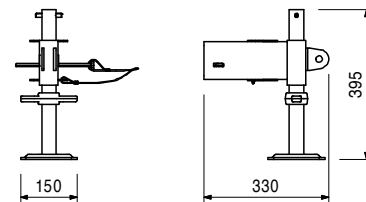
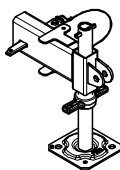

VGK Cantilevered Parapet Bracket



Item no.	Weight kg
124438	20.100

Formwork Support VGK 100

For connection of the bottom and lateral formwork.

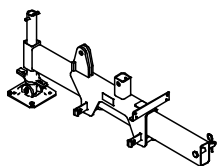

Complete with

1 pc. 118463 Bolt Ø 16 x 90, galv.
1 pc. 018060 Cotter Pin 4/1, galv.

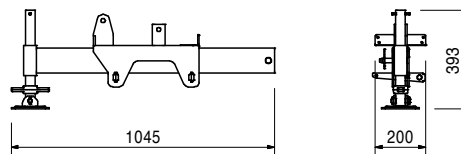

124371	7.300
--------	-------

Formwork Post VGK 70

For mounting of the lateral formwork.

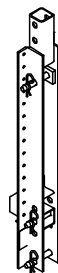

Complete with

3 pc. 118463 Bolt Ø 16 x 90, galv.
3 pc. 018060 Cotter Pin 4/1, galv.

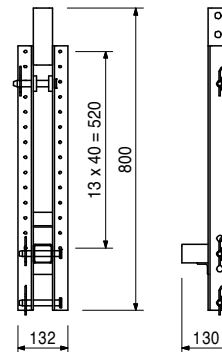

124360	4.500
--------	-------

Formwork Post Extension VGK 40

For extension of the Formwork Post VGK 70 with parapet height from 60 to 100 cm.



Complete with

2 pc. 118463 Bolt Ø 16 x 90, galv.
2 pc. 018060 Cotter Pin 4/1, galv.

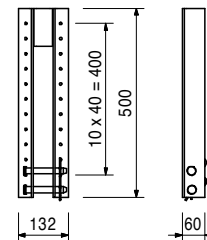

124934	1.750
--------	-------

Brace Connector VGK

For bracing due to longitudinal inclination.

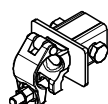

Complete with

1 pc. 710222 Bolt ISO 4014 M16 x 80-8.8, galv.
1 pc. 710229 Nut ISO 4032 M16-8, galv.

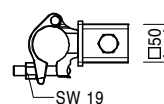

VGK Cantilevered Parapet Bracket

Item no.	Weight kg		L
		Scaffold Tubes Stell Ø 48.3	
026415	3.550	Scaff. Tube Steel Ø 48.3 x 3.2, special length	
026417	0.000	Cutting Cost Scaffold Tube	
026411	3.550	Scaff. Tube Steel Ø 48.3 x 3.2, l = 1.0 m	1000
026412	7.100	Scaff. Tube Steel Ø 48.3 x 3.2, l = 2.0 m	2000
026413	10.650	Scaff. Tube Steel Ø 48.3 x 3.2, l = 3.0 m	3000
026414	14.200	Scaff. Tube Steel Ø 48.3 x 3.2, l = 4.0 m	4000
026419	17.750	Scaff. Tube Steel Ø 48.3 x 3.2, l = 5.0 m	5000
026418	21.600	Scaff. Tube Steel Ø 48.3 x 3.2, l = 6.0 m	6000

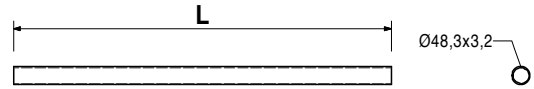
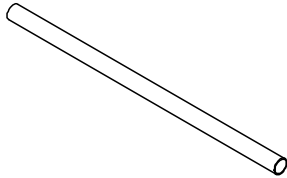

100242	4.570	Adj. Base Plate UJB 38-80/55	Note With captive yellow Quick Jack Nut.
--------	-------	-------------------------------------	--

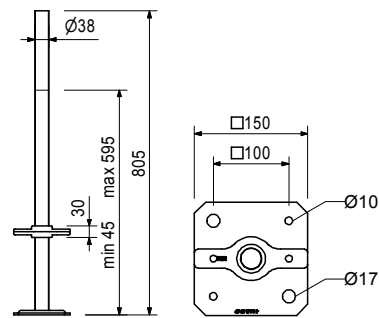
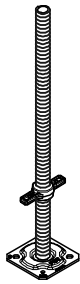

026230	1.010	Anchor Sleeve M24 To anchor platform systems.	Note Separate design information on request.
--------	-------	---	--

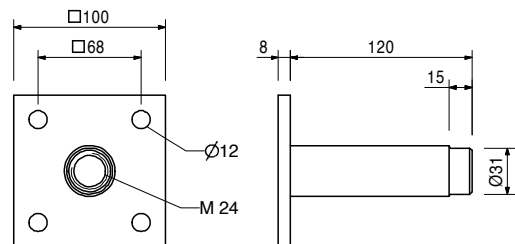
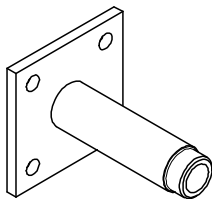

Accessories

026240	0.026	Cone PP Ø 31/26, c = 25
026250	0.005	Plug Ø 26 mm
116233	0.116	Cone FRC Ø 32/52, c = 40
026420	0.123	Anchor Positioning Stud M24, galv.
116234	0.033	Plug FRC Ø = 32
115150	0.200	Anchor Positioning Stud M24 x 65, galv.
123800	0.045	Metric Threaded Cone M24

VGK Cantilevered Parapet Bracket

Item no.	Weight kg
116233	0.116

Cone FRC Ø 32/52, c = 40

Ensures a concrete cover of 40 mm in conjunction with Anchor Sleeve M24. Made of fibre reinforced concrete.

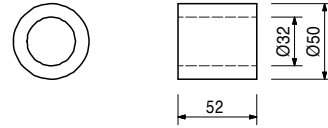
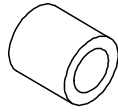

115150	0.200
--------	-------

Anchor Positioning Stud M24 x 65, galv.

For fixing the Anchor Sleeve M24 if fixation through formlining is not possible.

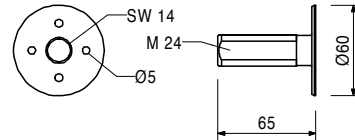
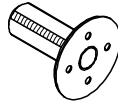

124031	0.452
--------	-------

Hex Bolt ISO 4014-M24 x 100-8.8, galv.

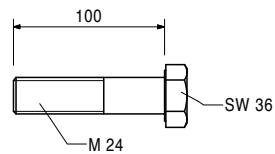
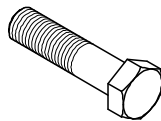

123800	0.045
--------	-------

Metric Threaded Cone M24

For pre-fixing of Anchor Sleeve M24 with a concrete cover of 40 mm in bridge cantilevers

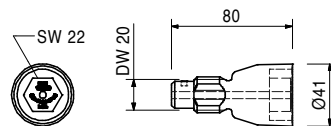
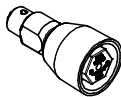

Accessories

026230	1.010
123820	0.063
129157	0.017

Anchor Sleeve M24

Plug FRC Ø 40

Nail 4.6 x 130

129157	0.017
--------	-------

Nail 4.6 x 130

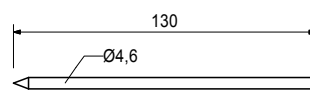
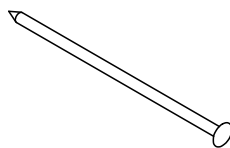

Item no.	Weight kg
123820	0.063

Plug FRC Ø = 40
For closing the tie hole when using Threaded Cone M24.

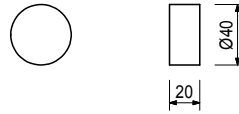

Accessories
Repoxxal Glue

031550	1.000
--------	-------

116234	0.033
--------	-------

Plug FRC Ø = 32
For closing the Cone FRC Ø 32. Made of fibre reinforced concrete.



Accessories
Repoxxal Glue

031550	1.000
--------	-------

031550	1.000
--------	-------

Repoxxal Glue
Two-component adhesive for bonding fibre reinforced concrete plugs.
Requirements: 1 kg adhesive for approx. 200 Plugs FZR 32 or 330 Plugs FZR 22.

Note
See Safety Data sheet!
Delivery unit 1.0 kg

030860	0.792
--------	-------

Threaded Anchor Plate DW 20
For use with Tie Rod DW 20, B 20 or Screw-On Cone-2 M24/DW 20. For anchoring in concrete.

Note
Lost anchor part.

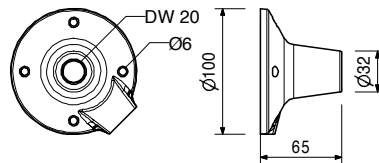
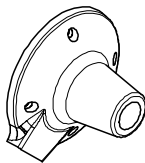

114158	1.030
--------	-------

Screw-On Cone-2 M24/DW 20, galv.
Anchor system M24.
For anchoring climbing systems.

Note
Separate design information on request.

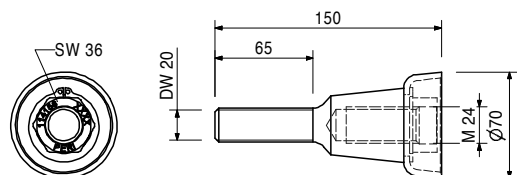
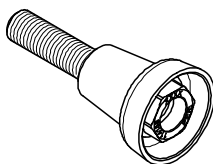

Accessories
Threaded Anchor Plate DW 20

030860	0.792
--------	-------

VGK Cantilevered Parapet Bracket

Item no.	Weight kg
026420	0.123

Anchor Positioning Stud M24, galv.
For fixing the M24 anchor system if the plywood formlining is not drilled through.

Note
Allen Key SW 14.

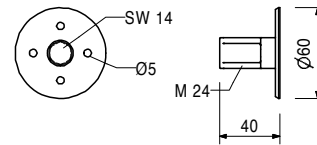

027212	0.445
710312	0.005

Accessories
Allen Key SW 14, long
Nail 3 x 80

026430	0.334
--------	-------

Bolt ISO 4014 M24 x 70-10.9, glav.
High-strength bolt for anchoring climbing systems.

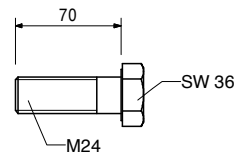
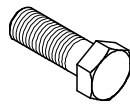

031652	0.247
--------	-------

KK Concrete Cone M24-67/52
For closing anchor points with Climbing Cone-2, M24/DW 15 and Screw-On Cone-2 M24/DW 20.

Note
Delivery unit 50 pieces.

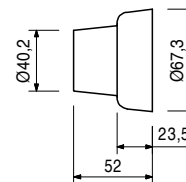
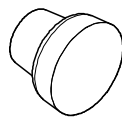

131709	9.980
--------	-------

Accessories
Sealing Adhesive-3, 6 cans-set

131709	9.980
--------	-------

Sealing Adhesive-3, 6 cans-set
For bonding PERI concrete cones.

Note
See Safety Data sheet!
Consisting of:
6 x Component A, 6 x Component B

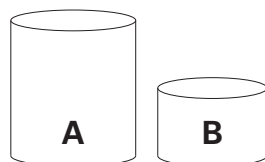

VGK Cantilevered Parapet Bracket



Item no.	Weight kg
114299	9.520

Guardrail Post GKB

For fixing to the reinforcement or to the embedded anchors.

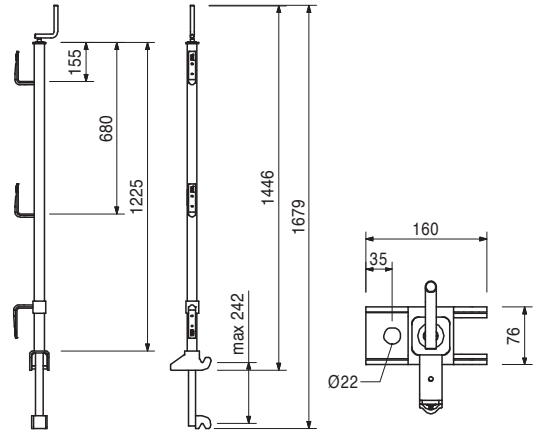

130012	0.337	Anchor Bold M16 - M24 x 50
--------	-------	-----------------------------------



129637	0.195	Chemical Anchor Sleeve IM 16 x 100
--------	-------	---



129628	0.555	Composite Mortar CF-T 300 V
--------	-------	------------------------------------



130013	0.010	Mixer CF-T 300 V
--------	-------	-------------------------



VGK Cantilevered Parapet Bracket

Item no.	Weight kg	
130014	1.160	Dispenser CF-T 300 V



130015	0.277	Blow Out Pump
--------	-------	----------------------

130011	0.084	Cleaning Brush D24
--------	-------	---------------------------

130623	0.016	T-Handle M6
--------	-------	--------------------

105032	0.070	Nut ISO 7042 M24-8, galv. Self-locking.
--------	-------	---

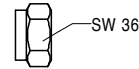

VGK Cantilevered Parapet Bracket



Item no.	Weight kg		L
075100	5.300	Girders GT 24	918
075120	7.100	Girder GT 24, l = 0.90 m	1214
075150	8.900	Girder GT 24, l = 1.20 m	1510
075180	10.600	Girder GT 24, l = 1.50 m	1806
075210	12.400	Girder GT 24, l = 1.80 m	2102
075240	14.200	Girder GT 24, l = 2.10 m	2398
075270	15.900	Girder GT 24, l = 2.40 m	2694
075300	17.700	Girder GT 24, l = 2.70 m	2990
075330	19.500	Girder GT 24, l = 3.00 m	3286
075360	21.200	Girder GT 24, l = 3.30 m	3582
075390	23.000	Girder GT 24, l = 3.60 m	3878
075420	24.800	Girder GT 24, l = 3.90 m	4174
075450	26.600	Girder GT 24, l = 4.20 m	4470
075480	28.300	Girder GT 24, l = 4.50 m	4766
075510	30.100	Girder GT 24, l = 4.80 m	5062
075540	31.900	Girder GT 24, l = 5.10 m	5358
075570	33.600	Girder GT 24, l = 5.40 m	5654
075600	35.400	Girder GT 24, l = 6.00 m	5950

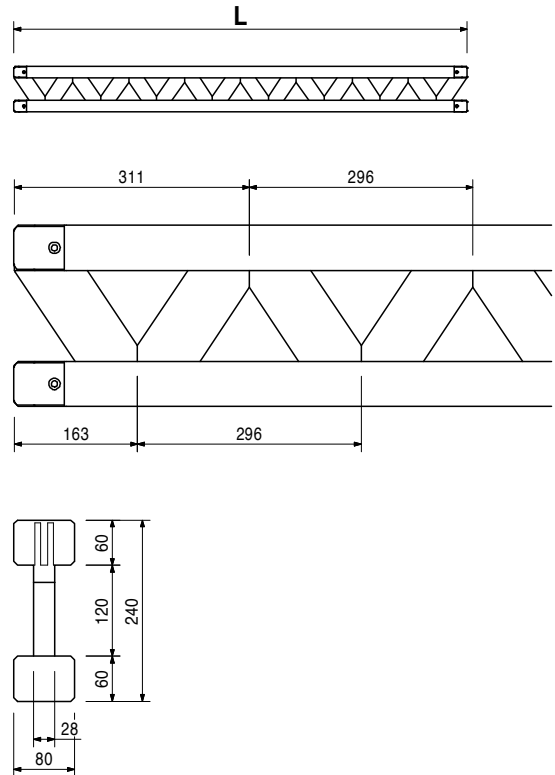
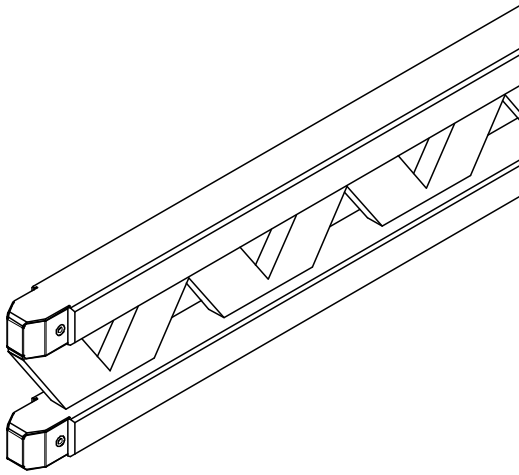

VGK Cantilevered Parapet Bracket



Item no.	Weight kg		L
		Girders VT 20K	
074990	8.600	Girder VT 20K, l = 1.45 m	1447
074905	12.700	Girder VT 20K, l = 2.15 m	2152
074910	14.500	Girder VT 20K, l = 2.45 m	2452
074890	15.600	Girder VT 20K, l = 2.65 m	2652
074920	17.100	Girder VT 20K, l = 2.90 m	2902
074930	19.500	Girder VT 20K, l = 3.30 m	3292
074940	21.200	Girder VT 20K, l = 3.60 m	3592
074950	23.000	Girder VT 20K, l = 3.90 m	3892
074960	26.700	Girder VT 20K, l = 4.50 m	4492
074970	29.900	Girder VT 20K, l = 4.90 m	4902
074980	34.800	Girder VT 20K, l = 5.90 m	5902

Universal formwork girder made of wood.

Note

The girder fulfils all requirements of DIN EN 13377 class P20 (Declaration of Conformity).

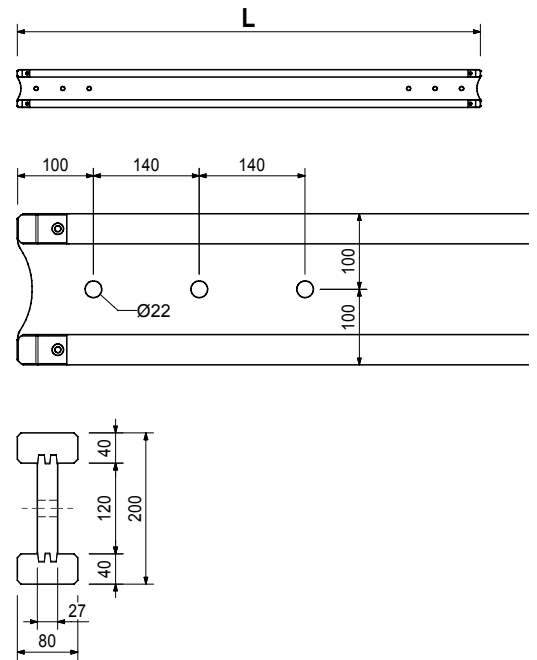
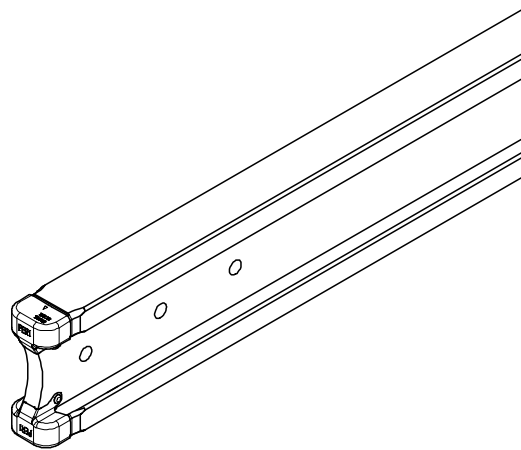

074900	0.000	Cutting Cost VT Girder
--------	-------	-------------------------------