

Product Catalogue

VTC Tunnel Carriage

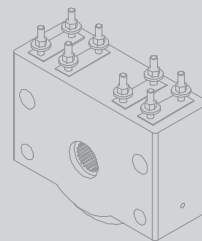

VTC Tunnel Carriage

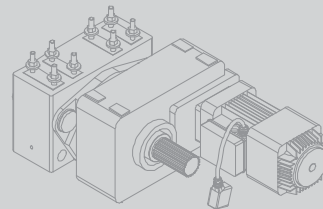
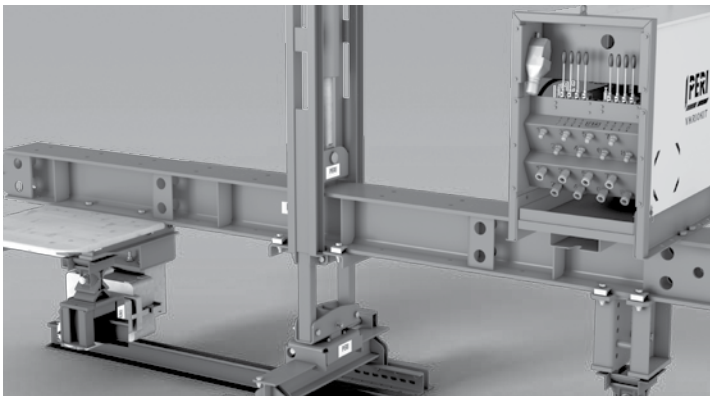

Item no.	Weight kg		L
129895	141.000	Longitudinal Beams VARIOKIT	
		Longitudinal Beam VARIOKIT 150	1500
129898	229.000	Longitudinal Beam VARIOKIT 250	2500
129901	273.000	Longitudinal Beam VARIOKIT 300	3000
129904	317.000	Longitudinal Beam VARIOKIT 350	3500
129907	448.000	Longitudinal Beam VARIOKIT 500	5000
129910	667.000	Longitudinal Beam VARIOKIT 750	7500
129913	886.000	Longitudinal Beam VARIOKIT 1000	10000

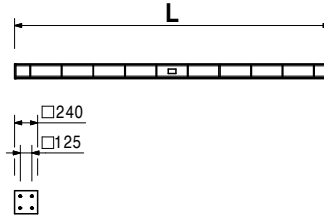
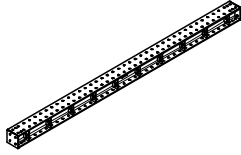

115599	53.300	Brace Connector-2 HD For connecting VARIOKIT struts to the Main Beam HDT. Bolted to the main beam.	Complete with 2 pc. 110023 Spacer M24-82 4 pc. 115145 Clamping Plate M16 Nova Grip 4 pc. 710226 Bolt ISO 4014 M20 x 90-8.8, galv. 4 pc. 108201 Nut DIN 980 M20-8, galv.
--------	--------	--	--

Technical Data

Min. locking torque for clamping screws 100 Nm.

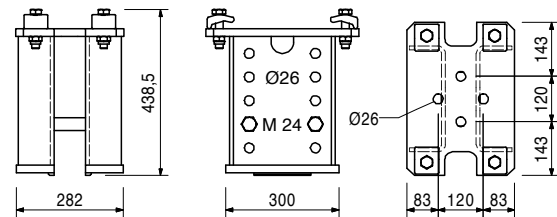
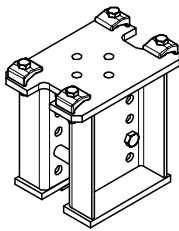

113770	32.200	Brace Support 250, Rail For transferring loads when using rails.	
--------	--------	--	--

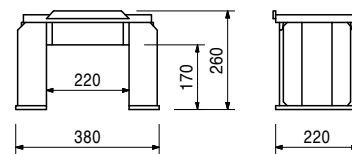
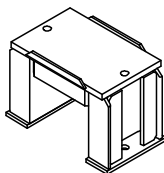

Item no.	Weight kg
111390	32.800

Climbing Rail Connector RCS 97

For rigidly connecting the Climbing Rails RCS.
With connection for the Heavy-Duty Spindles SLS.

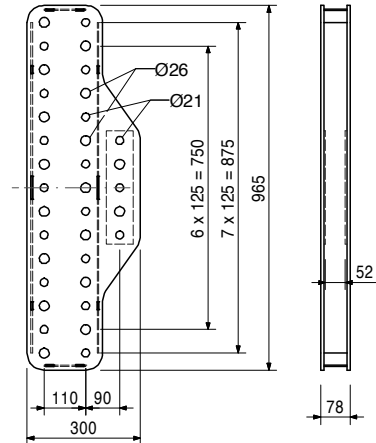
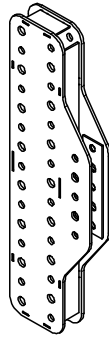

Accessories

104031	0.462	Fitting Pin Ø 21 x 120
018060	0.014	Cotter Pin 4/1, galv.
111567	0.729	Fitting Pin Ø 26 x 120
022230	0.033	Cotter Pin 5/1, galv.

113744	21.000
--------	--------

Climbing Rail Connector RCS 73

For rigid connection of Climbing Rails RCS. Perm. bending moment limited.

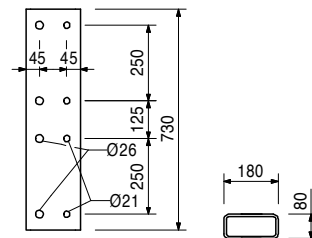
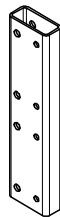

Accessories

104031	0.462	Fitting Pin Ø 21 x 120
018060	0.014	Cotter Pin 4/1, galv.
111567	0.729	Fitting Pin Ø 26 x 120
022230	0.033	Cotter Pin 5/1, galv.

111833	12.700
--------	--------

Climbing Rail Connector RCS 40

For an articulated connection or doubling of the RCS Climbing Rails.

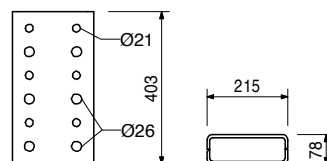
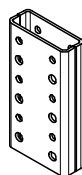

Accessories

104031	0.462	Fitting Pin Ø 21 x 120
018060	0.014	Cotter Pin 4/1, galv.
111567	0.729	Fitting Pin Ø 26 x 120
022230	0.033	Cotter Pin 5/1, galv.

VTC Tunnel Carriage



Item no.	Weight kg
109743	6.370

Climbing Rail Connector RCS 33
For an articulated connection of Climbing Rails RCS.

Complete with
3 pc. 710894 Pin \varnothing 25 x 180, geomet.
6 pc. 018060 Cotter Pin 4/1, galv.

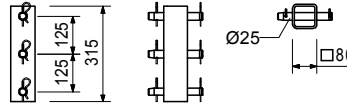
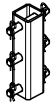

103737	10.800
--------	--------

Universal Coupling UK 70
For a rigid connection of Steel Walers SRU and for connecting Heavy-Duty Spindles SLS.

Note
Permissible load: see PERI Design Tables.

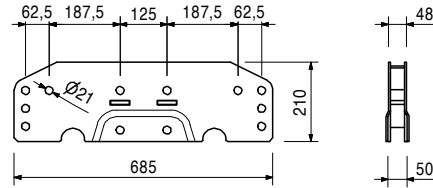
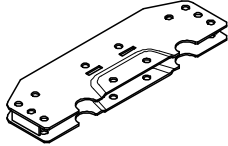

Accessories

104031	0.462
018060	0.014

Fitting Pin \varnothing 21 x 120
Cotter Pin 4/1, galv.

115623	5.060
--------	-------

Connector SRU VARIOKIT
For a rigid connection of Steel Walers SRU.

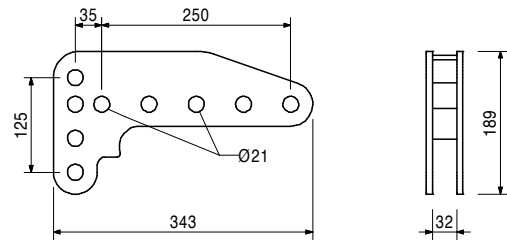
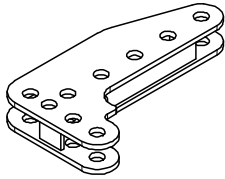

Accessories

104031	0.462
018060	0.014

Fitting Pin \varnothing 21 x 120
Cotter Pin 4/1, galv.

Item no.	Weight kg
111382	35.200

Climbing Rail Angle Connector RCS

For rigidly connecting the Climbing Rails RCS at right-angles, for frame construction or as bracket. With connection for the Heavy-Duty Spindle SLS and Tie Rod Cylinder Yoke SRU.

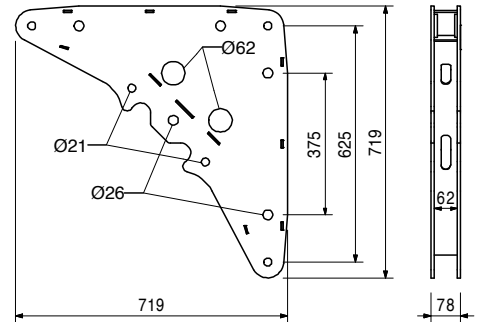
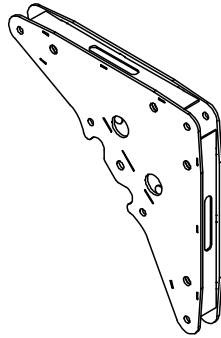

Accessories

104031	0.462	Fitting Pin Ø 21 x 120
018060	0.014	Cotter Pin 4/1, galv.
111567	0.729	Fitting Pin Ø 26 x 120
022230	0.033	Cotter Pin 5/1, galv.
110755	5.140	Tie Yoke SRU

111283	9.950
--------	-------

Angle Connector RCS/SRU

For right-angled connection of Steel Walers SRU to the Climbing Rails RCS and for attaching guardrail posts to Steel Walers SRU.

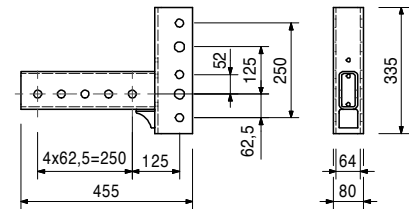
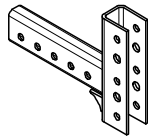

Accessories

104031	0.462	Fitting Pin Ø 21 x 120
018060	0.014	Cotter Pin 4/1, galv.
111567	0.729	Fitting Pin Ø 26 x 120
022230	0.033	Cotter Pin 5/1, galv.

111279	2.450
--------	-------

Cross Connector VARIOKIT

For right-angled connection of Steel Walers SRU or Climbing Rails RCS.

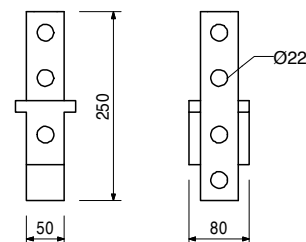
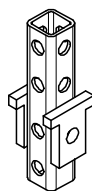

Accessories

104031	0.462	Fitting Pin Ø 21 x 120
018060	0.014	Cotter Pin 4/1, galv.

Item no.	Weight kg
123509	13.400

Cross Connector RCS

For crosswise connection of Climbing Rails RCS.

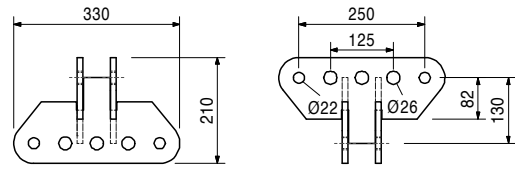
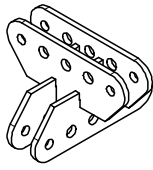

104031	0.462
018060	0.014
111567	0.729
022230	0.033

Accessories

Fitting Pin Ø 21 x 120

Cotter Pin 4/1, galv.

Fitting Pin Ø 26 x 120

Cotter Pin 5/1, galv.

113933	17.100
--------	--------

Adjusting Unit VARIOKIT

For an articulated connection of Steel Walers SRZ and SRU. With integrated adjustment feature.

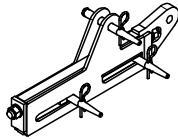

Complete with

3 pc. 104031 Fitting Pin Ø 21 x 120

3 pc. 018060 Cotter Pin 4/1, galv.

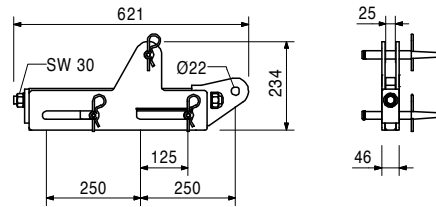

104031	0.462
018060	0.014

Accessories

Fitting Pin Ø 21 x 120

Cotter Pin 4/1, galv.

022001	17.900
--------	--------

Waler Hinge, galv.

For an articulated connection of Steel Walers SRZ and SRU.

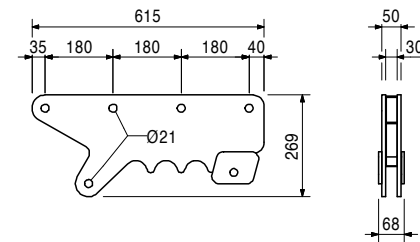
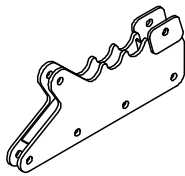

022002	18.500
--------	--------

Waler Hinge adjustable, galv.

For an articulated connection of Steel Walers SRZ and SRU. With integrated adjustment feature.

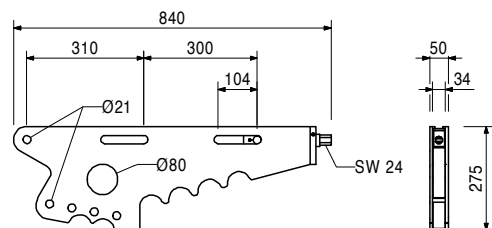
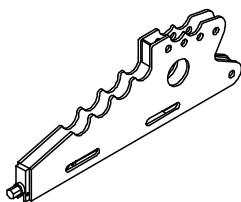

VTC Tunnel Carriage



Item no.	Weight kg
123497	15.700

Spindle Bracket VARIOKIT

For mounting Heavy-Duty-Spindles SLS to the Climbing Rail RCS with little spindle inclination.

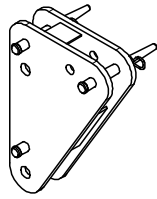

Complete with

3 pc. 104031 Fitting Pin \varnothing 21 x 120
3 pc. 018060 Cotter Pin 4/1, galv.

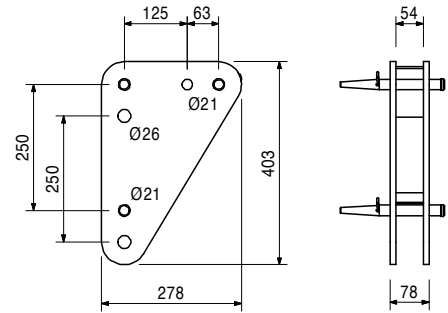

123513	37.800
--------	--------

Slide Connector VARIOKIT

For right-angled and slidable T-connection of Climbing Rails RCS.

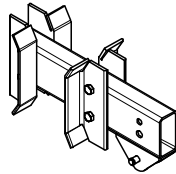

Complete with

1 pc. 104031 Fitting Pin \varnothing 21 x 120
1 pc. 018060 Cotter Pin 4/1, galv.

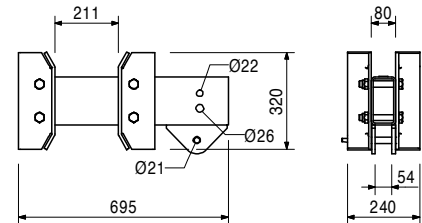

115553	316.000
--------	---------

Drive Unit VARIOKIT

Driving engine with attached gear Box.

Note

Item 117027 becomes for Drive Unit 2x require.

Technical Data

Motor drive output: 0.6 KW
Movement speed: 3.0 m/min.

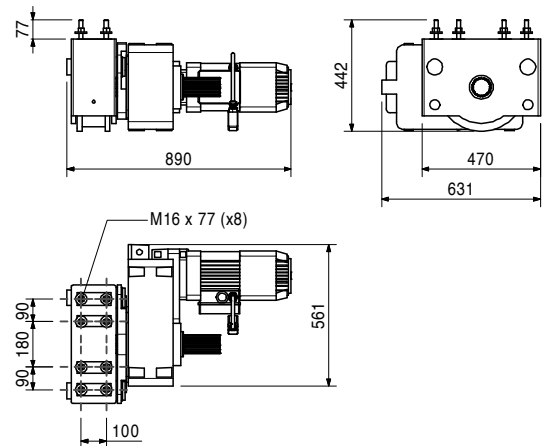
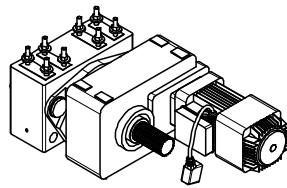

Accessories

117027	10.200
--------	--------

Carrier Platform Moving Unit

Item no.	Weight kg
115554	119.000

Wheel Block VARIOKIT

Wheel Block can be used in combination with Drive Unit VARIOKIT or without.

Note

The Drive Unit is directly bolted to the wheel block.

Technical Data

Permissible load-bearing capacity 184.8 kN.

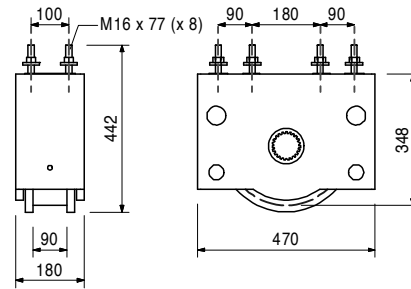
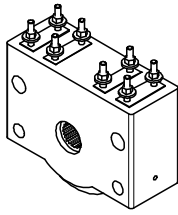

115549	35.000
--------	--------

Control Cabinet Drive Unit VARIOKIT

Control cabinet to operate a maximum of 4 drive units, using a plugin operating switch.

Technical Data

Cabinet dimensions 600 x 380 x 310 mm plus projection of plug and socket power supply: 380 V / 16 A.

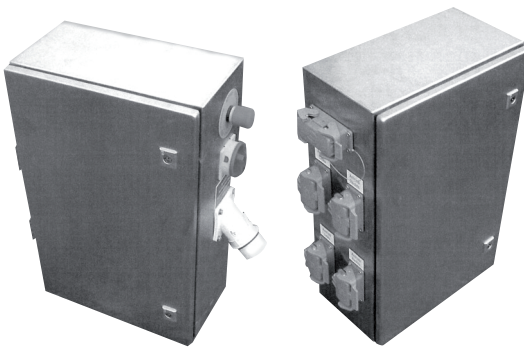

115550	5.000
--------	-------

Operating Switch Drive Unit VARIOKIT

Operating switch matching with control cabinet to handle the drive units.

Technical Data

Length of connecting cable 10 m.



VTC Tunnel Carriage

Item no.	Weight kg
115551	5.000
115552	15.000

Cable Connections VARIOKIT
Cable Connection VARIOKIT 3 m
Cable Connection VARIOKIT 25 m
 To connect the drive units with the Control Cabinet VARIOKIT.

Note
 Cables can be switched in series.

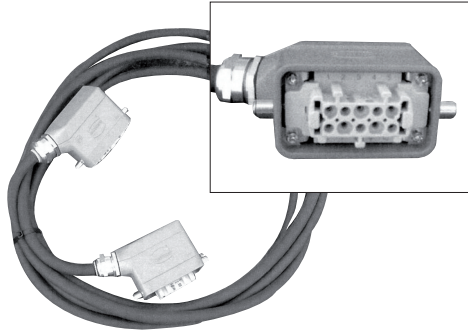

114572 72.000 **Connector Driving Unit 300 VK**

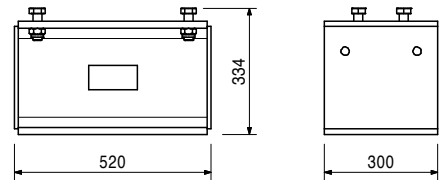
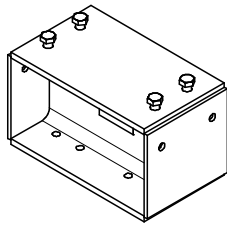

126852 241.000 **Hydraulic Unit VARIOKIT 8-cycles**
 Hydraulic pump for shuttering and striking of up to 8 Hydraulic cylinders (extendable up to 5 Way Valve Units, Quad, item-no. 128338).

Note
 Follow Instructions for Use!
 Use only original PERI hydraulic oil HVCP 46.

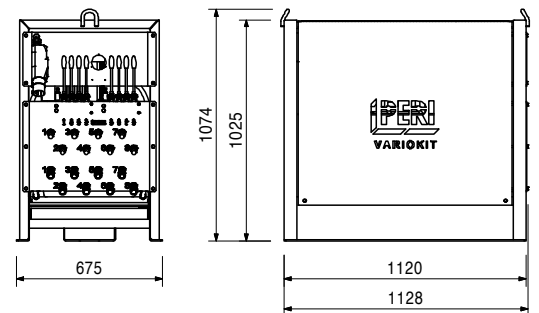
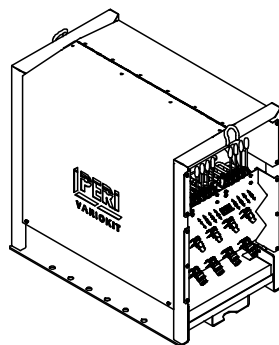

VTC Tunnel Carriage

Item no.	Weight kg		
110280	0.500	Adapter Cable RCS For the power supply to the Hydraulic Pump RCS.	Note Follow Instructions for Use! With CEE plug connector 400 V 16 A.

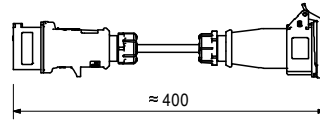
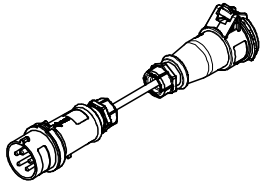

110279	0.250	Plug Socket RCS, black For providing the power supply to the Hydraulic Pump RCS with 380 – 460 V, 50 – 60 Hz.	Note Follow Instructions for Use!
--------	-------	---	---

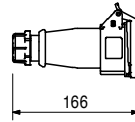

127480	55.200	Hydraulic Cylinder VARIOKIT Ø 120 - 300	Note Follow Instructions for Use!
--------	--------	--	---

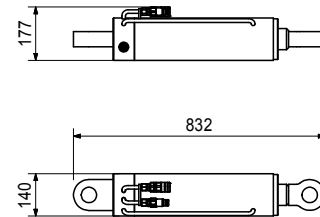
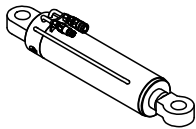

127400	1.490	Accessories Pin 40 x 160	
--------	-------	------------------------------------	--

127481	21.500	Hydraulic Cylinder VARIOKIT Ø 60 - 650	Note Follow Instructions for Use!
--------	--------	---	---

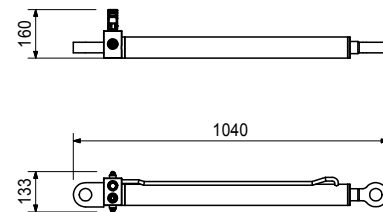
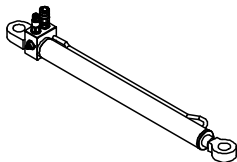

127400	1.490	Accessories Pin 40 x 160	
--------	-------	------------------------------------	--

VTC Tunnel Carriage



Item no.	Weight kg	
127400	1.490	Pin 40 x 160

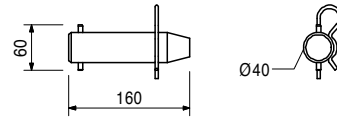
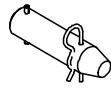

128338	4.200	Way Valve Unit - Quad
--------	-------	------------------------------

With more than 8 cylinders which can be controlled with the connectors of the hydraulic unit a connection is used to connect further way valve units.

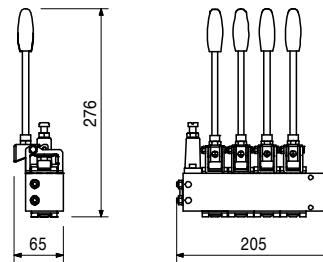
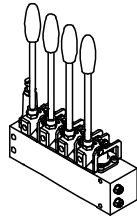

110069	8.500	Hydraulic Twin Hoses RCS
110070	15.300	Hydraulic Twin Hose RCS, 10 m Hydraulic Twin Hose RCS, 20 m

For connecting Hydraulic Pump RCS with the Climbing Device RCS 50 and LPS 30. With quick-release connectors.

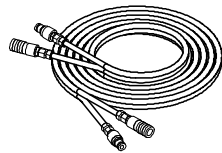

Complete with
2 pc. 110822 Quick Coupler Bushing RCS
2 pc. 110823 Quick Coupler Nipple RCS

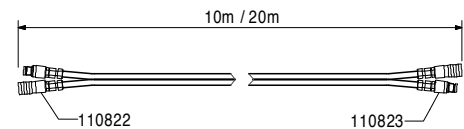

057376	18.300	Hydraulic Oil ISO 11158 HVI46, 20 l High quality synthetic hydraulic oils for PERI Hydraulic Units.
--------	--------	---

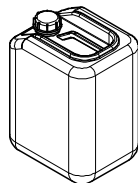

Note
Observe the safety data sheet and applicable national safety regulations regarding hydraulic oil, in particular for transport, storage and disposal! Observe the technical documentation for the hydraulic unit! Product data sheet on request.

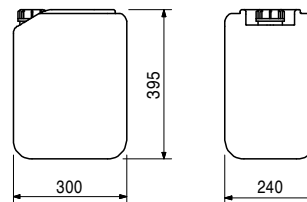

Item no.	Weight kg	
110822	0.297	Quick Coupler Bushing RCS

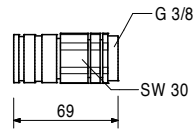
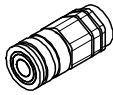

110823	0.171	Quick Coupler Nipple RCS
--------	-------	---------------------------------

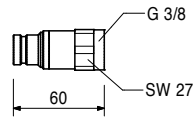

125632	0.050	Protect. Covers Climb. Device RCS Spare part. To protect the quick couplers against dirt and damage.
--------	-------	--

Technical Data
1 set for 1 Climbing Device RCS 50 (2x bushing and 2x nipple each).

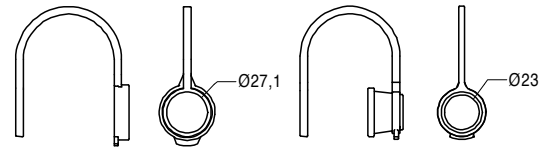
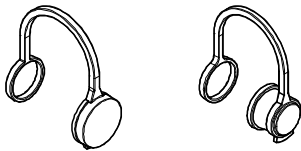

129035	0.996	Hydraulic Hoses EN 853 2SN DN08
129036	1.430	Hydraulic Hose EN 853 2SN DN08 1.0 m Hydraulic Hose EN 853 2SN DN08 2.0 m Hydraulic hoses with quick-release couplings at both ends and nominal diameter 8 mm.

L	X
1169	1000
2169	2000

Complete with
1 pc. 128992 Pin ISO16028 DN10 R3/8IG
1 pc. 128993 Sleeve ISO16028 DN10 R3/8IG
2 pc. 051750 Male Stud Coupler X-GE12PSR-ED
1 pc. 129424 FF-Coupling Pair X-GE 12PSR-ED

Note
Follow applicable Safety Regulations for the installation and maintenance of hydraulic lines!

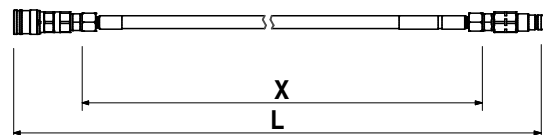
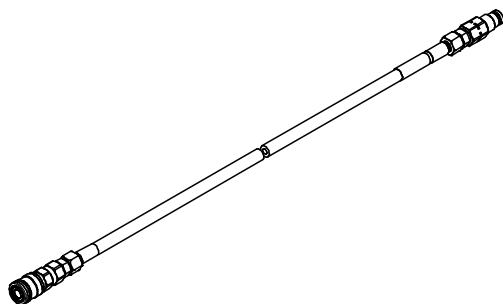

VTC Tunnel Carriage

Item no.	Weight kg
129419	2.690
129420	4.900
129421	7.120
129422	9.330

Hydraulic Hoses 2SN-DN08-FF

Hydr. Hose 2SN-DN08-FF 5.0 m

Hydr. Hose 2SN-DN08-FF 10.0 m

Hydr. Hose 2SN-DN08-FF 15.0 m

Hydr. Hose 2SN-DN08-FF 20.0 m

Hydraulic hoses with quick-release couplings at both ends and nominal diameter 8 mm.

L	X
5170	5000
10170	10000
15170	15000
20170	20000

Complete with

1 pc. 128992 Pin ISO16028 DN10 R3/8IG

1 pc. 128993 Sleeve ISO16028 DN10 R3/8IG

2 pc. 051750 Male Stud Coupler X-GE12PSR-ED

1 pc. 129424 FF-Coupling Pair X-GE 12PSR-ED

Note

Follow applicable Safety Regulations for the installation and maintenance of hydraulic lines!

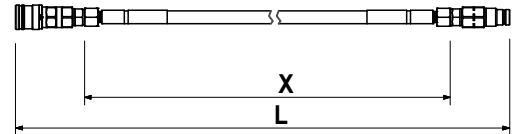
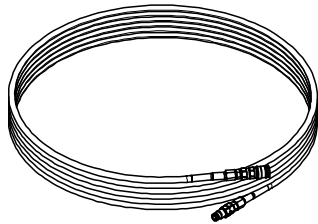

126646 0.651 **Bypass Hose RCS**

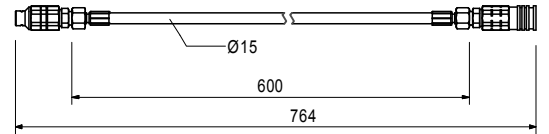
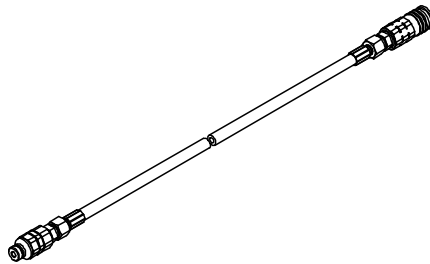

129423 1.370 **Hydr. T-Piece 2SN-DN08-FF**

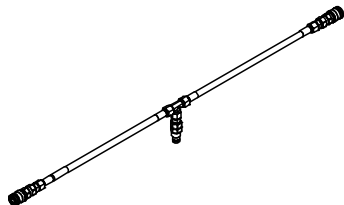

Complete with

2 pc. 128993 Sleeve ISO16028 DN10 R3/8IG

1 pc. 128992 Pin ISO16028 DN10 R3/8IG

3 pc. 051750 Male Stud Coupler X-GE12PSR-ED

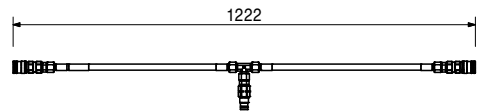

Item no.	Weight kg
115581	10.280

Hydraulic Service Case

Consisting of:

- 1 pc. 115590 Tool Box 580 x 260 x 285 mm
- 6 pc. 115583 Pressure Gauge Typ 570 VA-Geh.
- 6 pc. 115584 Hose MKT 6-02 DN 02
- 12 pc. 115582 Measuring Coupl. SMK 20-G 1/4-PC
- 2 pc. 115591 Double Spanner SW 10 x 13
- 1 pc. 115592 Double Spanner SW 13 x 17
- 1 pc. 115588 Double Spanner SW 19 x 24
- 1 pc. 051778 Double Spanner SW 24 x 27
- 1 pc. 115589 Double Spanner SW 27 x 32
- 1 pc. 057278 Allen Key Set, 8 pcs.
- 1 pc. 115585 Allen Key SW 12
- 1 pc. 057279 Allen Key SW 14
- 1 pc. 115587 Standard Screwdriver 6.5 mm
- 1 pc. 057282 Pipe Wrench
- 1 pc. 115147 Angle Fitting Set PS
- 2 pc. 115396 Fitting Set PS

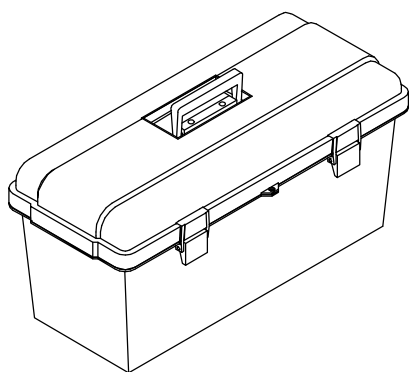

128336

0.200

Return Flow Filter Element

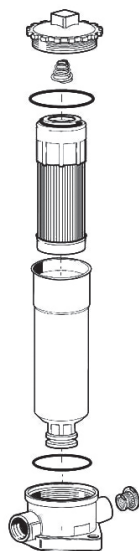

Item no.	Weight kg	
128537	0.002	O-ring 57 x 3, DIN 3771

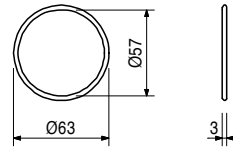

128538	0.002	O-ring 50 x 2, DIN 3771
--------	-------	--------------------------------

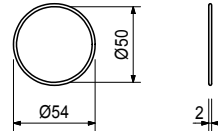

128337	0.002	CU-Gasket 20 x 24 x 1.5
--------	-------	--------------------------------

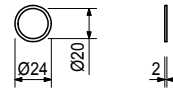

115009	21.700	Concrete Pump Connector BPA-2 Ø 125 For connecting concrete feed pipes to the formwork.
--------	--------	---

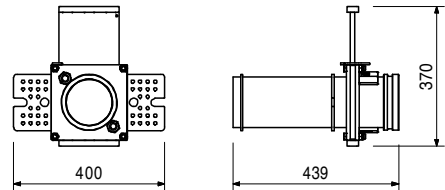
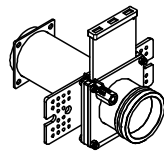

108688	1.810	Adapter TRIO BPA Ø 125 For attaching the Concrete Pump Connector BPA Ø 125 to TRIO Panels.
--------	-------	--

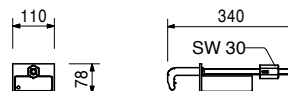
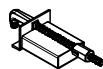

Item no.	Weight kg
108543	4.900

Coupling BPA Ø 125

Suitable for all standard concrete feed lines with Ø 125 mm or 5.5"

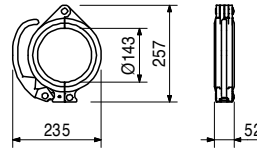

115010	6.400
--------	-------

Clear Slide BPA-2 Ø 125

For removing residual concrete from the Concrete Pump Connector BPA-2 Ø 125.

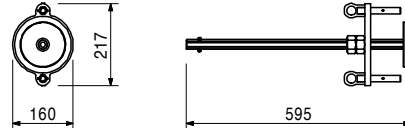
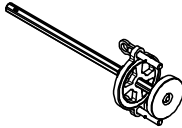

022010	379.000
--------	---------

Main Beam HDT 280

System steel girder for use with HD 200 Main Beam areas and special constructions. Profile HEB 300.

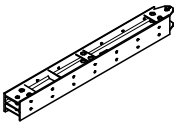

Complete with

- 1 pc. 105435 Bolt Ø 50 x 330
- 1 pc. 722457 Dowel Pin Ø 10 x 70, galv.
- 1 pc. 710618 Cotter Pin 8, galv.

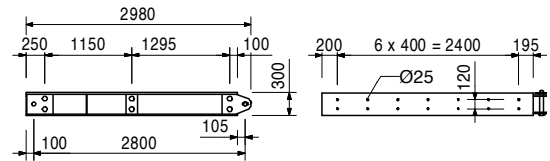

022009	582.000
--------	---------

Main Beam HDT 440

System steel girder for use with HD 200 Main Beam areas and special constructions. Profile HEB 300.

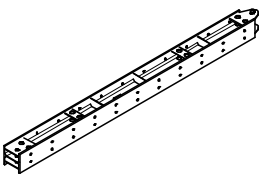

Complete with

- 1 pc. 105435 Bolt Ø 50 x 330
- 1 pc. 722457 Dowel Pin Ø 10 x 70, galv.
- 1 pc. 710618 Cotter Pin 8, galv.

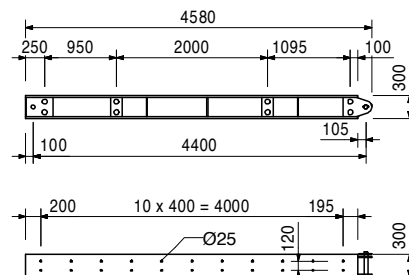

VTC Tunnel Carriage

Item no.	Weight kg
022008	1130.000

Main Beam HDT 880

System steel girder for use with HD 200 Main Beam areas and special constructions. Profile HEB 300.

Complete with

- 1 pc. 105435 Bolt \varnothing 50 x 330
- 1 pc. 722457 Dowel Pin \varnothing 10 x 70, galv.
- 1 pc. 710618 Cotter Pin 8, galv.

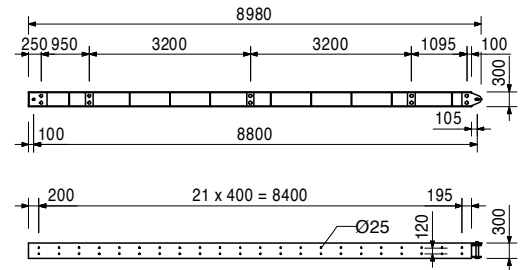
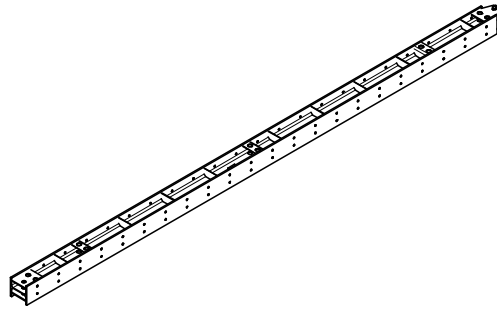

115074	81.900
--------	--------

Beam Starter HDT

Access aid for HDT Main Beams onto the heavy duty rollers. Holes and connectors match the HDT Main Beam.

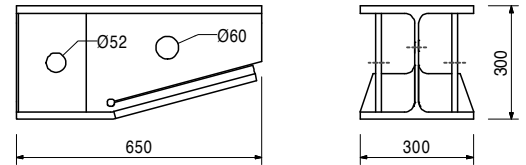
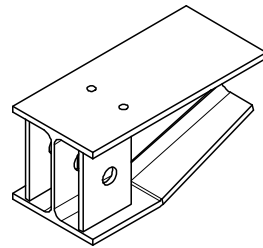

112548	51.100
112549	56.500

Truss Struts HD

Truss Strut HD 2000

Truss Strut HD 2247

For assembling truss girders with Main Beam HDT.

Complete with

- 2 pc. 112547 Pin HD \varnothing 40 x 260

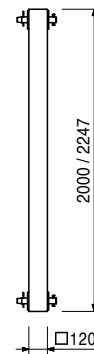

Item no.	Weight kg
112558	34.900

Truss Bracket HD
For assembly on the Main Beam HDT.

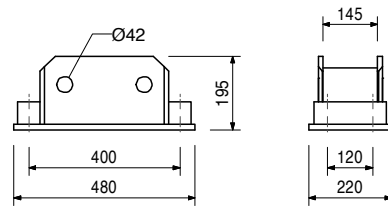
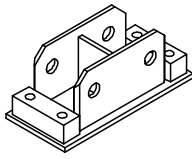

112547	2.490
--------	-------

Pin HD Ø 40 x 260
For connecting the Truss Strut HD with the Truss Bracket HD.

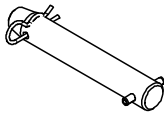

Complete with
1 pc. 022230 Cotter Pin 5/1, galv.
1 pc. 722457 Dowel Pin Ø 10 x 70, galv.

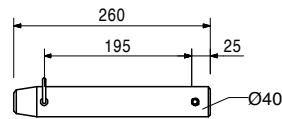

112816	12.100
--------	--------

Spindle Spreader VARIOKIT
For connecting spindles or Climbing Rail RCS transversely to the Main Beam HDT.

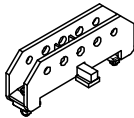

Complete with
2 pc. 714093 Bolt ISO 4014 M16 x 70-8.8, galv.
2 pc. 710229 Nut ISO 4032 M16-8, galv.
2 pc. 711074 Washer ISO 7089 200 HV, A 16, galv.
2 pc. 112815 Clamping Plate M16 Nova Grip

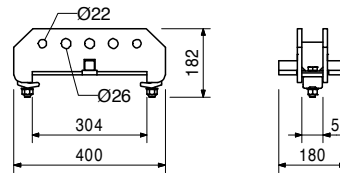

118404	165.000
--------	---------

Strut VARIOKIT I = 275 - 450

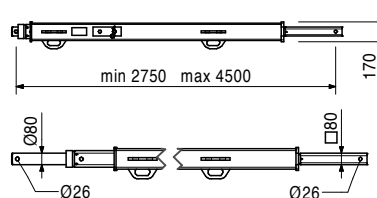
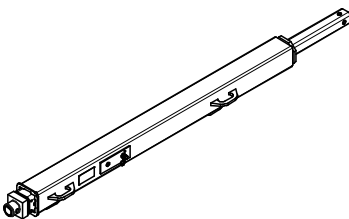

VTC Tunnel Carriage

Item no.	Weight kg
112840	239.000
112841	295.000

Struts VARIOKIT
Strut VARIOKIT I = 400 - 700
Strut VARIOKIT I = 600 - 900
 For the bracing of system solutions.

Note
 Permissible load: see PERI Design Tables.

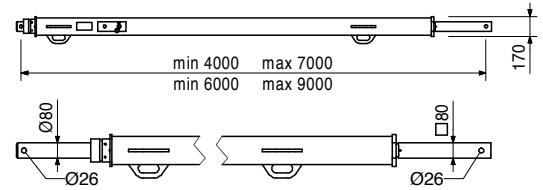
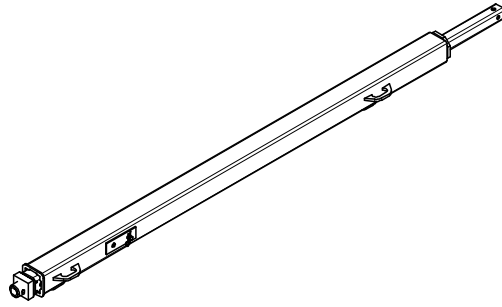

Item no.	Weight kg
111567	0.729
022230	0.033

Accessories
Fitting Pin Ø 26 x 120
Cotter Pin 5/1, galv.

116469	5.920
--------	-------

Wheel RCS 1.5 t
 For assembling in Climbing Rails RCS, foldable.

Complete with
 2 pc. 113012 Pin Ø 20 x 260, galv.
 2 pc. 018060 Cotter Pin 4/1, galv.
Technical Data
 Permissible load-bearing capacity 1.5 t.

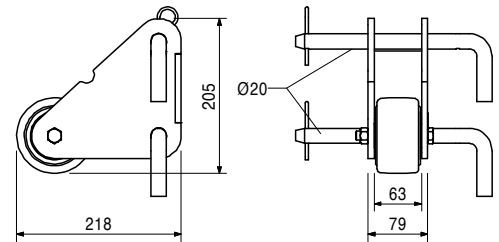
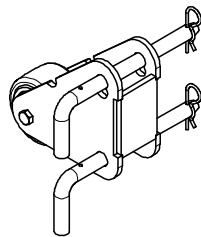

024590	32.000
--------	--------

Wedge Lowering Device 420 kN, painted
 For releasing and lowering large loads.

Note
 Take Type Test into consideration.
 Wrench size SW 46.
Technical Data
 Separate Design Information on request.

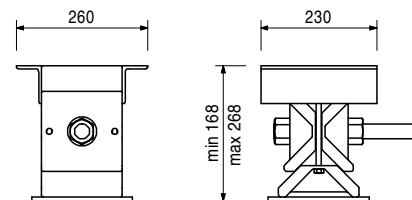
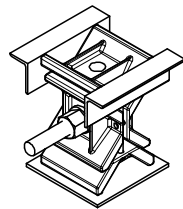

Item no.	Weight kg
117930	53.300

Wedge Lowering Device 1000 kN, painted
For releasing and lowering large loads.

Note
Take Type Test into consideration.
Wrench size SW 46.
Technical Data
Separate Design Information on request.

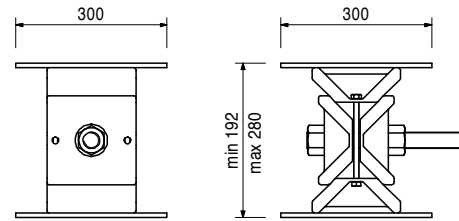
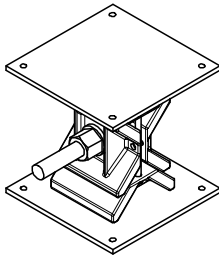

111274	13.600
--------	--------

Heavy Duty Roller Bracket VARIOKIT
For connecting the heavy-duty roller 150 kN, item no. 022040 and 200 kN, item no. 022041 to Steel Waler SRU.

Complete with
4 pc. 721817 Bolt ISO 4014 M10 x 50-8.8, galv.
4 pc. 710381 Nut ISO 7042 M12-8, galv.
4 pc. 780702 Washer ISO 7089 200 HV, A 12, galv.
2 pc. 710226 Bolt ISO 4014 M20 x 90-8.8, galv.
2 pc. 781053 Nut ISO 7040 M20-8, galv.

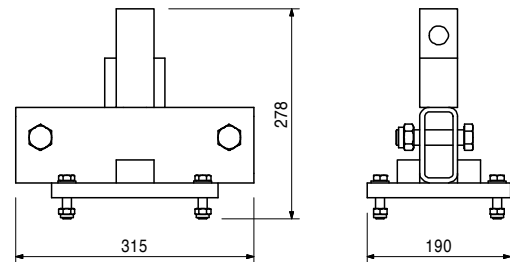
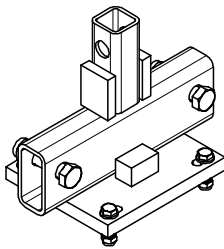

022040	8.400
--------	-------

Heavy Duty Roller 150 kN, Type B-II
Moving device for special and heavy-duty constructions.

Technical Data
Permissible load-bearing capacity 150 kN.

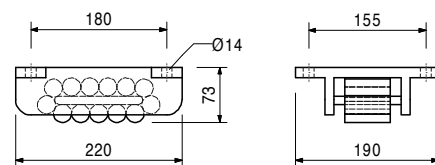
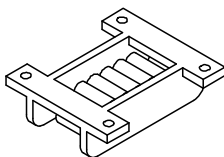

Item no.	Weight kg
022041	11.700

Heavy Duty Roller 200 kN, Type A-II
 Moving device for special and heavy-duty constructions.

Technical Data
 Permissible load-bearing capacity 200 kN.

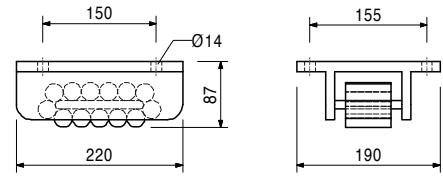
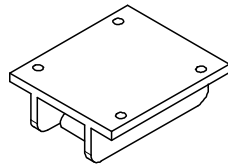

022042	14.100
--------	--------

Heavy Duty Roller 300 kN, Type B-III
 Moving device for special and heavy-duty constructions.

Technical Data
 Permissible load-bearing capacity 300 kN.

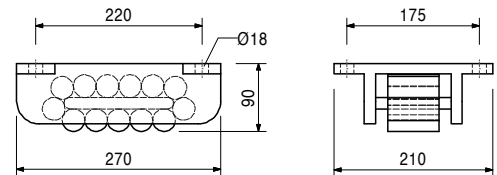
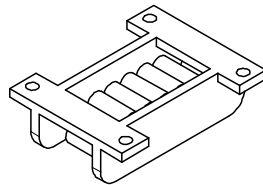

114335	24.000
--------	--------

Heavy Duty Roller 340 kN, Type H-III
 Moving device for special and heavy-duty constructions.

Technical Data
 Permissible load-bearing capacity 340 kN.

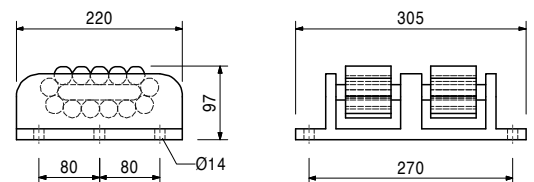
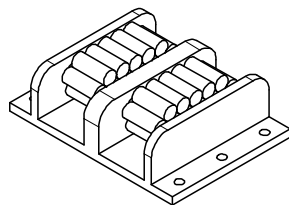

022044	19.300
--------	--------

Heavy Duty Roller 400 kN, Type A-III
 Moving device for special and heavy-duty constructions.

Technical Data
 Permissible load-bearing capacity 400 kN.

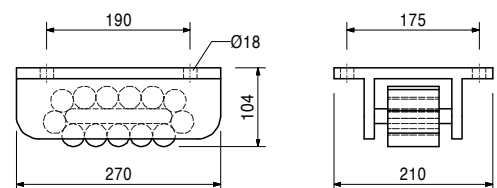
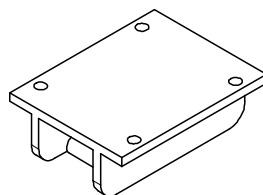

Item no.	Weight kg
110012	23.400

Diagonal Strut RCS 212
For bracing RCS Framework Brackets.

Complete with
2 pc. 109612 Bolt ISO 4014 M24 x 130-8.8, galv.
1 pc. 105032 Nut ISO 7042 M24-8, galv.

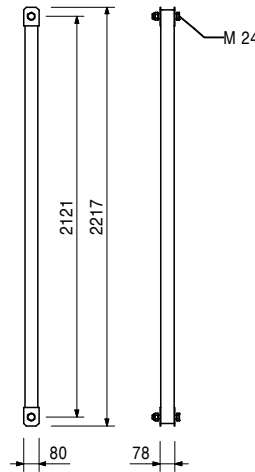
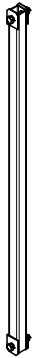

116469	5.920
--------	-------

Wheel RCS 1.5 t
For assembling in Climbing Rails RCS, foldable.

Complete with
2 pc. 113012 Pin $\varnothing 20 \times 260$, galv.
2 pc. 018060 Cotter Pin 4/1, galv.
Technical Data
Permissible load-bearing capacity 1.5 t.

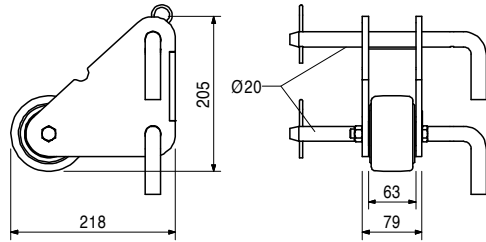
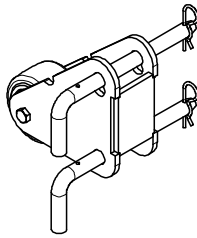

115616	3.210
--------	-------

Waler Jack with Connector VARIOKIT
Used as connector part and adjustable compression point.

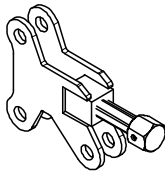
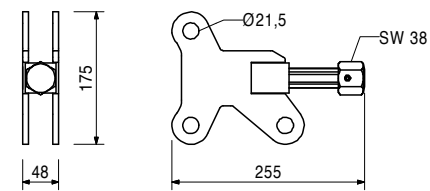

Item no.	Weight kg
104083	5.630

Waler Connector FTF/SRU

For assembly of a horizontal Steel Waler SRU on the FTF Bracket 500 or vertical Steel Walers SRU. With connection for scaffold tube.

Complete with

3 pc. 105822 Bolt \varnothing 20 x 102, galv.
3 pc. 018060 Cotter Pin 4/1, galv.

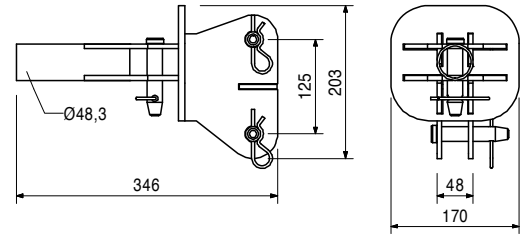
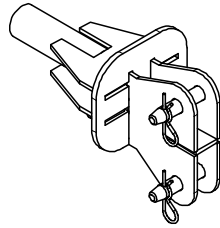

103945	1.870
--------	-------

Scaffold Tube Connector FTF

For connecting scaffold tubes to the Steel Walers SRU.

Complete with

2 pc. 105822 Bolt \varnothing 20 x 102, galv.
2 pc. 018060 Cotter Pin 4/1, galv.

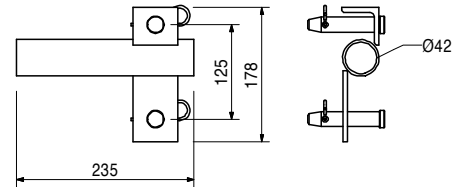
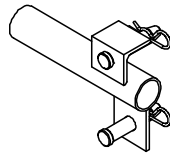

115682	5.770
--------	-------

Height Adjustment VARIOKIT

For height adjustment of Steel Walers SRU.

Complete with

2 pc. 104031 Fitting Pin \varnothing 21 x 120
2 pc. 018060 Cotter Pin 4/1, galv.

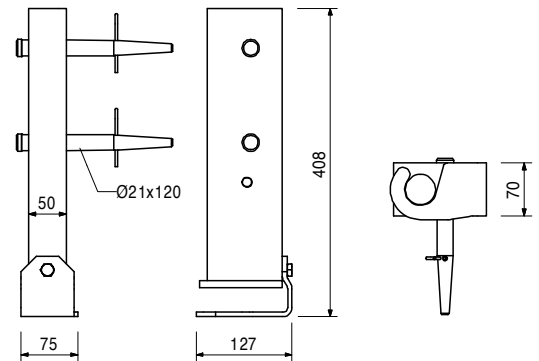
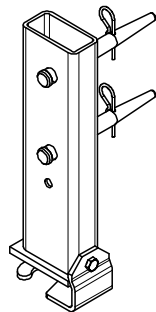

Accessories

100411	3.390
100242	4.570

Adj. Base Plate UJB 38-50/30

Adj. Base Plate UJB 38-80/55

Item no.	Weight kg	
100411	3.390	Adj. Base Plate UJB 38-50/30

Note
With captive red Quick Jack Nut.

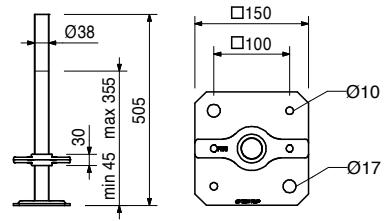
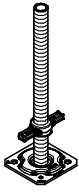

100242	4.570	Adj. Base Plate UJB 38-80/55
--------	-------	-------------------------------------

Note
With captive yellow Quick Jack Nut.

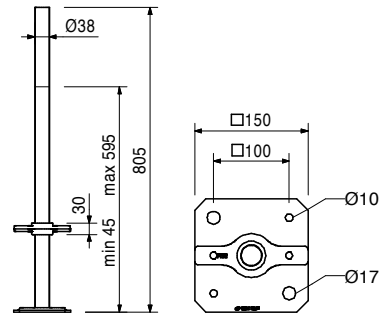
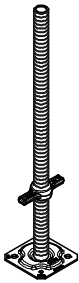

109630	4.240	Spindle Head SRU For connecting the Steel Walers SRU and SRZ to the shoring.
--------	-------	--

Note
With captive Quick Jack Nut.

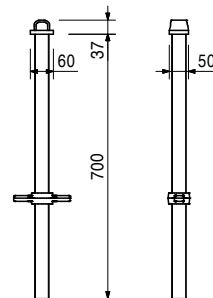
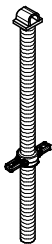

Accessories		
104031	0.462	Fitting Pin Ø 21 x 120
018060	0.014	Cotter Pin 4/1, galv.

114618	1.450	Spindle Counter Plate VARIOKIT For transferring the spindle load into SRU/SRZ.
--------	-------	--

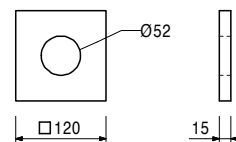
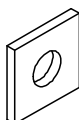

Item no. Weight kg

024000	0.131	Compensation Washer
024180	0.126	Compensation Washer 16, yellow galv. Compensation Washer 20, galv. For assembling in the VKZ holes.

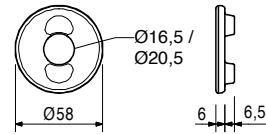

Accessories

024910	0.303	Bolt ISO 4014 M20 x 100-8.8, galv.
710219	0.184	Bolt ISO 4014 M16 x 100-8.8, galv.
781053	0.065	Nut ISO 7040 M20-8, galv.
070890	0.030	Nut ISO 7040 M16-8, galv.

131404	1.080	Screw-On Coupler-2 EN74 HT B C2 D48-M20 For Screwing Scaffold Tubes Ø 48 mm to components up to 9 mm thickness.
--------	-------	---

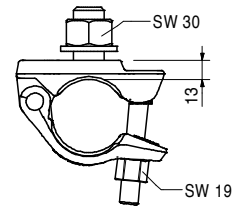
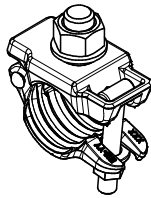

130045	1.640	Scaffold Tube Adapter Ø 48 Alpha
--------	-------	---

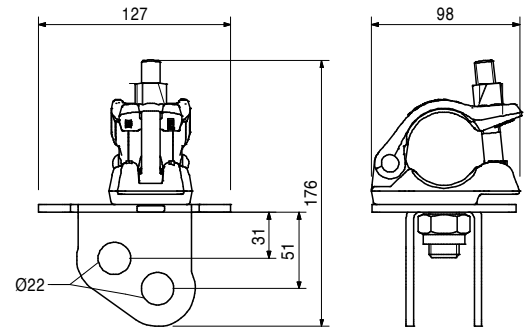
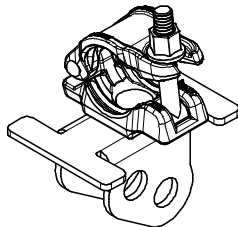

110084	2.310	Scaffold Tube Adapter Ø 48 RCS For connecting Scaffold Tubes Ø 48 mm to Climbing Rails RCS.
--------	-------	---

Complete with
 1 pc. 017040 Screw-On Coupler AK 48, galv.
 1 pc. 710894 Pin Ø 25 x 180, geomet.
 2 pc. 018060 Cotter Pin 4/1, galv.

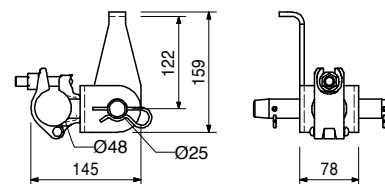
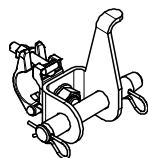

Item no. Weight kg

104031 0.462

Fitting Pin Ø 21 x 120
For different connections.

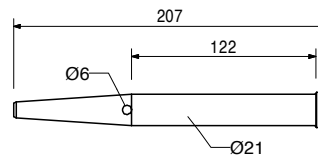
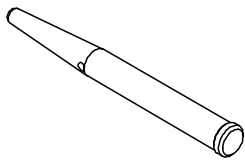

Accessories

018060 0.014

Cotter Pin 4/1, galv.

111567 0.729

Fitting Pin Ø 26 x 120
For different connections.

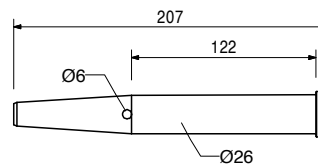
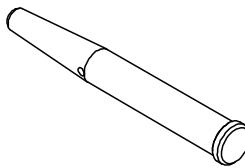

Accessories

022230 0.033

Cotter Pin 5/1, galv.

105400 0.330

Pin Ø 20 x 140, galv.
For different connections.

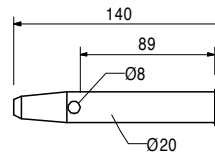
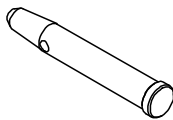

Accessories

018060 0.014

Cotter Pin 4/1, galv.

022230 0.033

Cotter Pin 5/1, galv.

018060 0.014

Cotter Pin 4/1, galv.

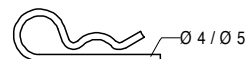

Item no.	Weight kg
104131	3.940

Guardrail Holder SRU/SRZ

For assembling a guardrail to the Steel Walers SRU and SRZ, Profile U100 to U140.

Complete with

2 pc. 105400 Pin \varnothing 20 x 140, galv.
2 pc. 018060 Cotter Pin 4/1, galv.

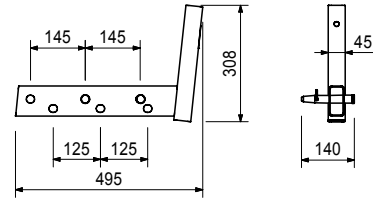
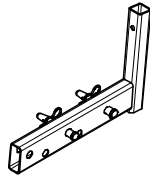

Accessories

116292	4.720
061260	6.150

Guardrail Post HSGP-2

Guardrail Post SGP

101290	5.670
--------	-------

Guardrail Holder GT 24 / VT 20

For assembling a guardrail to GT 24 and VT 20 Girders.

Complete with

1 pc. 105400 Pin \varnothing 20 x 140, galv.
1 pc. 018060 Cotter Pin 4/1, galv.

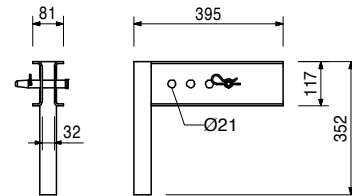
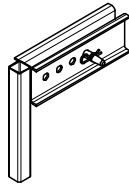

Accessories

116292	4.720
061260	6.150

Guardrail Post HSGP-2

Guardrail Post SGP

126088	4.390
--------	-------

Guardrail Post Holder Multi

For fixing of an end guardrail post on Girders GT 24, VT 20 or Timbers 80/160.
Fixing of the guardrail posts by means of Hex. Bolts M20 or Clamp A64.

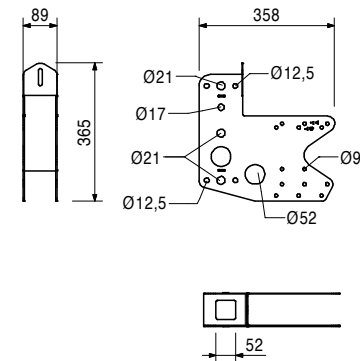
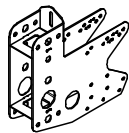

Accessories

710285	0.050
024090	0.005
024470	0.008

Bolt ISO 4014 M8 x 100-8.8, galv.

Nut ISO 4032 M8-8, galv.

TSS-Torx 6 x 60, galv.

VTC Tunnel Carriage



Item no.	Weight kg
114557	7.050

Platform Beam SRU

For assembling a platform and guardrail at vertical Steel Waler SRU.

Complete with

2 pc. 104031 Fitting Pin \varnothing 21 x 120
2 pc. 018060 Cotter Pin 4/1, galv.

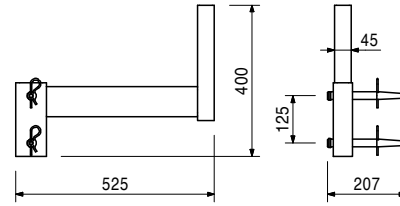
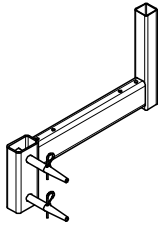

Accessories

116292	4.720
--------	-------

Guardrail Post HSGP-2

116292	4.720
--------	-------

Guardrail Post HSGP-2

As guardrail for different systems.

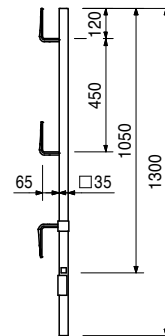

061260	6.150
--------	-------

Guardrail Post SGP

As guardrail for different systems.

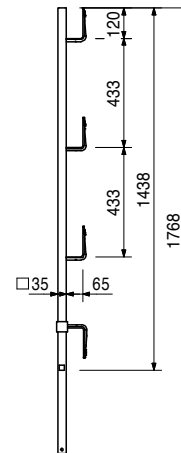

Item no.	Weight kg
019040	6.480

Guardrail Post PD 8

As guardrail for different systems. Screwed onto sub-structure.

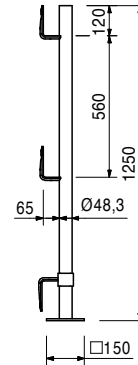

116363	0.089
--------	-------

Spacer RCS 184

Compensator between Angle Connector RCS/SRU and Guardrail Post RCS 184.

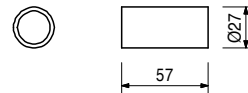

114328	16.600
--------	--------

Guardrail Post RCS/SRU 184

For assembly of the guardrail on the Platform Beam RCS/SRU or Angle Connector RCS/SRU.

Complete with

2 pc. 114727 Bolt ISO 4017 M20 x 100-8.8, galv.
2 pc. 781053 Nut ISO 7040 M20-8, galv.

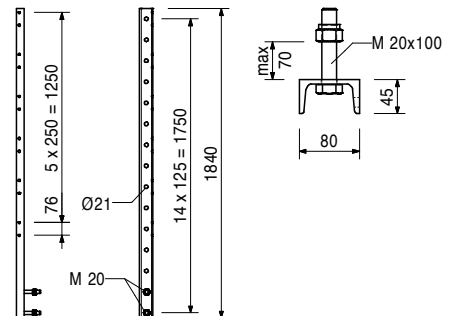

Item no.	Weight kg
109720	26.600

Guardrail Post RCS 226

For assembly of the guardrail on the main platform with RCS Formwork Scaffolding or as horizontal strut in the bracing.

Complete with

2 pc. 104477 Bolt ISO 4014 M20 x 120-8.8, galv.
2 pc. 781053 Nut ISO 7040 M20-8, galv.

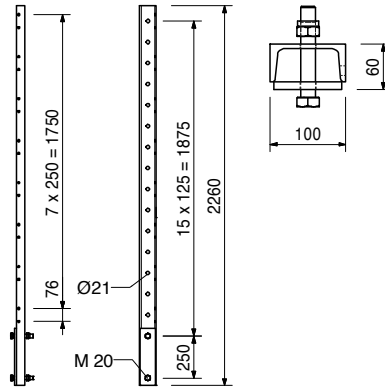

109721	40.700
109773	67.900

Guardrail Posts RCS

Guardrail Post RCS 384

Guardrail Post RCS 509

For assembly of the guardrail on the intermediate and finishing platforms with RCS Formwork Scaffolding or as horizontal strut in the bracing.

Complete with

1 pc. 104477 Bolt ISO 4014 M20 x 120-8.8, galv.
1 pc. 781053 Nut ISO 7040 M20-8, galv.

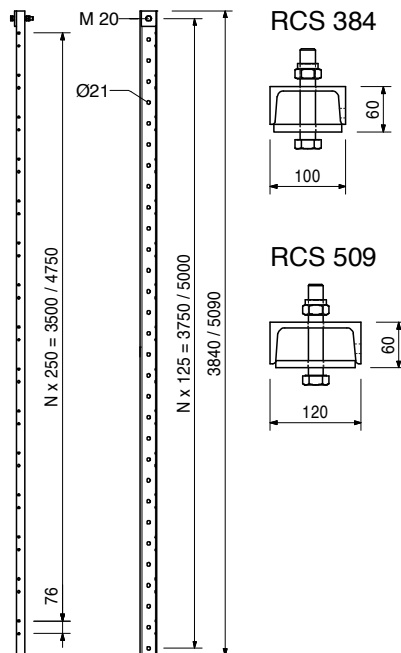

Item no.	Weight kg
126495	24.200

Guardrail Post RCS-MP

For fixation of the side protection on Material Platforms RCS-MP with horizontal Climbing Rail RCS.

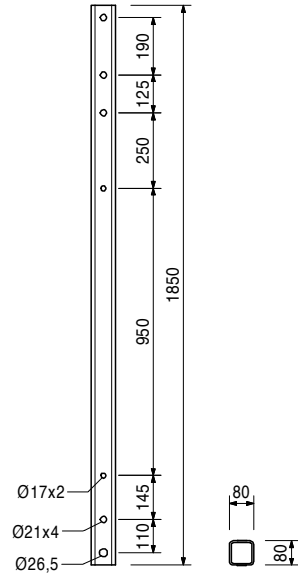

104477	0.300
781053	0.065
104031	0.462
018060	0.014

Accessories

Bolt ISO 4014 M20 x 120-8.8, galv.

Nut ISO 7040 M20-8, galv.

Fitting Pin Ø 21 x 120

Cotter Pin 4/1, galv.

110296	0.220
--------	-------

Clamp A64 DIN 3570 M12, galv.

For assembling Scaffold Tubes Ø 48 or Ø 60.

Note

Wrench size SW 19.

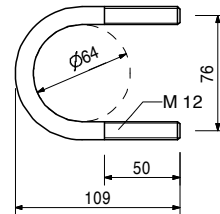
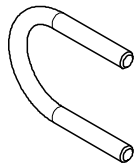

710330	0.017
--------	-------

Accessories

Nut ISO 4032 M12-8, galv.

Item no.	Weight kg		L
075100	5.300	Girders GT 24	918
075120	7.100	Girder GT 24, l = 0.90 m	1214
075150	8.900	Girder GT 24, l = 1.50 m	1510
075180	10.600	Girder GT 24, l = 1.80 m	1806
075210	12.400	Girder GT 24, l = 2.10 m	2102
075240	14.200	Girder GT 24, l = 2.40 m	2398
075270	15.900	Girder GT 24, l = 2.70 m	2694
075300	17.700	Girder GT 24, l = 3.00 m	2990
075330	19.500	Girder GT 24, l = 3.30 m	3286
075360	21.200	Girder GT 24, l = 3.60 m	3582
075390	23.000	Girder GT 24, l = 3.90 m	3878
075420	24.800	Girder GT 24, l = 4.20 m	4174
075450	26.600	Girder GT 24, l = 4.50 m	4470
075480	28.300	Girder GT 24, l = 4.80 m	4766
075510	30.100	Girder GT 24, l = 5.10 m	5062
075540	31.900	Girder GT 24, l = 5.40 m	5358
075570	33.600	Girder GT 24, l = 5.70 m	5654
075600	35.400	Girder GT 24, l = 6.00 m	5950

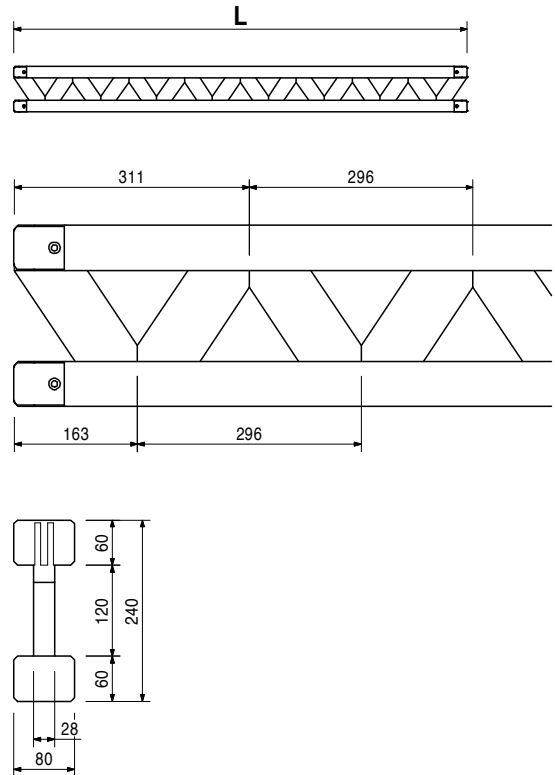
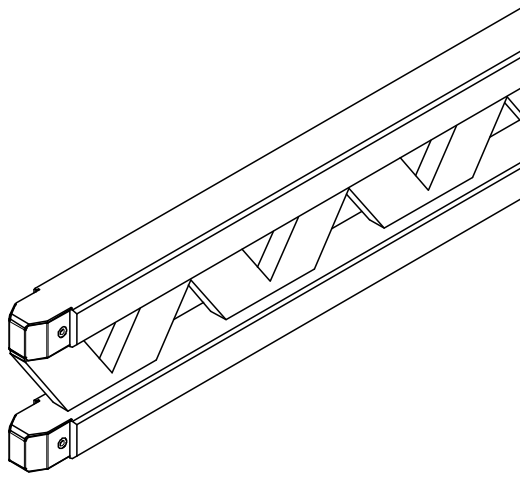

Item no.	Weight kg		L
		Girders VT 20K, with Steel Cap	
074990	8.600	Girder VT 20K, l = 1.45 m	1447
074905	12.700	Girder VT 20K, l = 2.15 m	2152
074910	14.500	Girder VT 20K, l = 2.45 m	2452
074890	15.600	Girder VT 20K, l = 2.65 m	2652
074920	17.100	Girder VT 20K, l = 2.90 m	2902
074930	19.500	Girder VT 20K, l = 3.30 m	3292
074940	21.200	Girder VT 20K, l = 3.60 m	3592
074950	23.000	Girder VT 20K, l = 3.90 m	3892
074960	26.700	Girder VT 20K, l = 4.50 m	4492
074970	29.900	Girder VT 20K, l = 4.90 m	4902
074980	34.800	Girder VT 20K, l = 5.90 m	5902

Universal formwork girder made of wood.

Note

The girder fulfils all requirements of DIN EN 13377 class P20 (Declaration of Conformity).

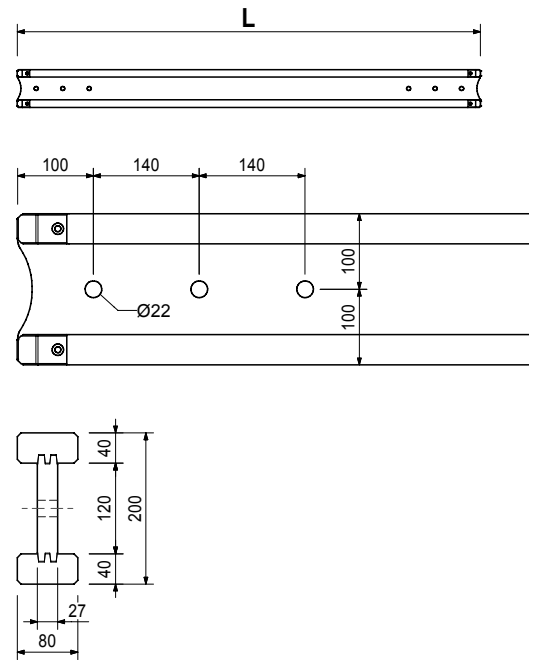
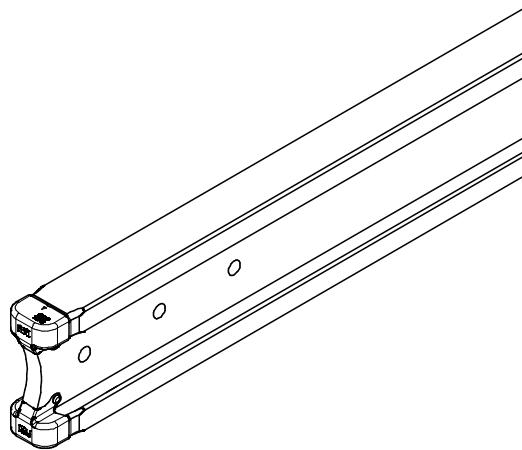

074900	0.000	Cutting Cost VT Girder
--------	-------	-------------------------------

Item no.	Weight kg		L
		Girders VT 20, without Steel Cap	
073710	8.600	Girder VT 20 l = 1.45 m	1445
073720	12.700	Girder VT 20 l = 2.15 m	2150
073730	14.500	Girder VT 20 l = 2.45 m	2450
073740	15.600	Girder VT 20 l = 2.65 m	2650
073750	17.100	Girder VT 20 l = 2.90 m	2900
073760	19.500	Girder VT 20 l = 3.30 m	3290
073770	21.200	Girder VT 20 l = 3.60 m	3590
073780	23.000	Girder VT 20 l = 3.90 m	3890
073790	26.700	Girder VT 20 l = 4.50 m	4490
073800	29.900	Girder VT 20 l = 4.90 m	4900
073810	34.800	Girder VT 20 l = 5.90 m	5900

024070 0.691 **Hook Strap HB 24-100/120, galv.**
 For fixing GT 24 Girders to Steel Walers SRZ, SRU and BR: U100 – U120.

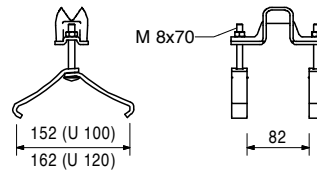
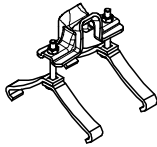

024080 0.735 **Hook Strap HB 24-140/160, galv.**
 For fixing GT 24 Girders to Steel Walers SRZ, SRU and BR: U140 – U160.

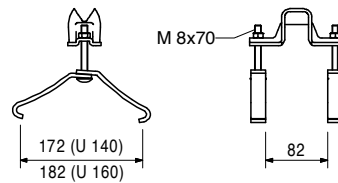
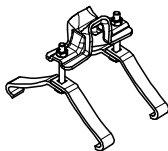

Item no.	Weight kg
----------	-----------

104931	0.865
103845	0.893

Hook Straps Uni HBU
Hook Strap Uni HBU 20-24
Hook Strap Uni HBU 24-28

For fixing GT 24 Girders or VT 20 Girders to Steel Walers SRZ and SRU Profiles U100 – U140.

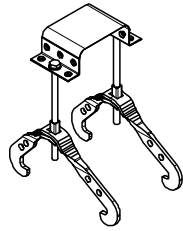

Note

The girders can be mounted at right-angles or diagonally to the steel walers and also outside of the nodes.

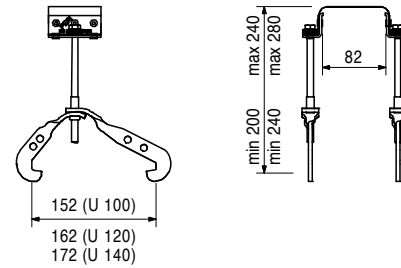

Accessories

024540	0.005
--------	-------

TSS-Torx 6 x 40, galv.

104930	0.887
104096	0.912

Hook Straps Uni Double HBUD
Hook Strap Uni Double HBUD 20-24
Hook Strap Uni Double HBUD 24-28

For fixing two GT 24 Girders or VT 20 Girders to SRZ Steel Walers and SRU Profiles U100 – U140.

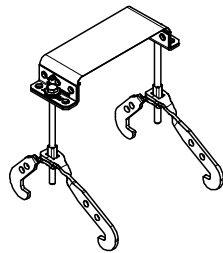

Note

The girders can be mounted at right-angles or diagonally to the steel walers and also outside of the nodes.

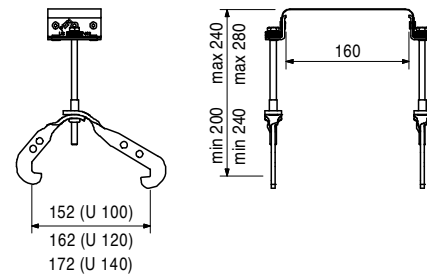

024860	0.616
--------	-------

Hook Strap HB 24 QB 150, galv.

For fixing GT 24 Girders independent from girder node and timber beams to Steel Walers SRZ, SRU and BR: U100 – U120.

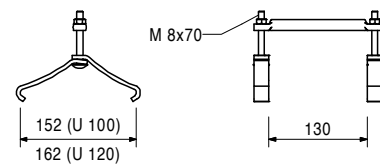
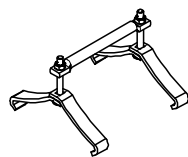

024600	0.907
--------	-------

Girder Claw HB

For mounting the GT 24 Edge Girder on the Steel Waler SRZ and SRU Profile U100 – U120.

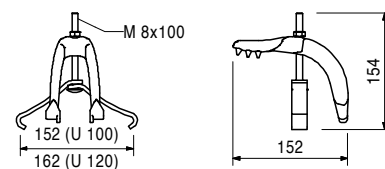
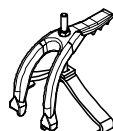

VTC Tunnel Carriage



Item no.	Weight kg
024640	0.923

Quick Str. Hook Strap 24-100/140, galv.

For fixing GT 24 Girders to Steel Waler SRZ, SRU, Profile U100 – U140 outside of the girder nodes.

Note

Girders fixed in position with the quick strap must be specially screwed to the formlining when using crane lifting gears.

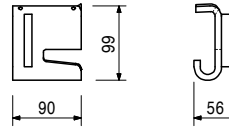
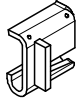

024630	0.742
--------	-------

Fix Strap U100 – U120, galv.

For fixing the GT 24 Girder in the VARIO Corner.

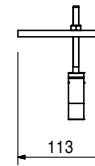
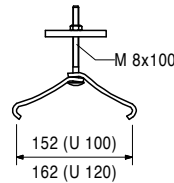

114166	78.200	Climbing Rail RCS
109469	130.000	Climbing Rail RCS 148
112102	156.000	Climbing Rail RCS 248
109470	182.000	Climbing Rail RCS 298
112141	209.000	Climbing Rail RCS 348
109471	262.000	Climbing Rail RCS 398
109472	393.000	Climbing Rail RCS 498
109610	524.000	Climbing Rail RCS 748
		Climbing Rail RCS 998

Steel profile for all-purpose use of climbing application or civil constructions. With Spacers M20-82 and M24-82.

L

1480
2480
2980
3480
3980
4980
7480
9980

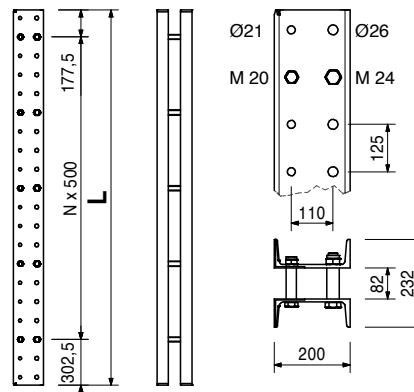

110022	0.491
--------	-------

Spacer M20-82

Spacer for Climbing Rails RCS.

Complete with

1 pc. 104477 Bolt ISO 4014 M20 x 120-8.8, galv.
1 pc. 130341 Nut ISO 7042 M20-8, galv.

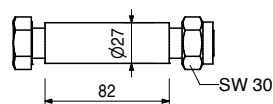
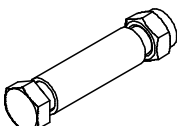

VTC Tunnel Carriage



Item no.	Weight kg
110023	0.910

Spacer M24-82
Spacer for Climbing Rails RCS.

Complete with

1 pc. 109612 Bolt ISO 4014 M24 x 130-8.8, galv.
1 pc. 130342 Nut ISO 7042 M24-8, galv.

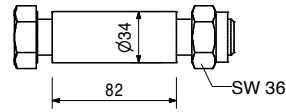
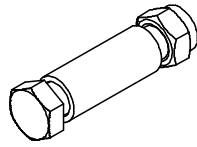

		Steel Walers Universal SRU U120	L
103868	18.100	Steel Waler Universal SRU U120, l = 0.72 m	722
103871	24.200	Steel Waler Universal SRU U120, l = 0.97 m	972
123809	29.500	Steel Waler Universal SRU U120, l = 1.17 m	1172
103874	30.900	Steel Waler Universal SRU U120, l = 1.22 m	1222
103877	38.100	Steel Waler Universal SRU U120, l = 1.47 m	1472
103886	44.700	Steel Waler Universal SRU U120, l = 1.72 m	1722
125088	46.100	Steel Waler Universal SRU U120, l = 1.77 m	1772
103889	52.000	Steel Waler Universal SRU U120, l = 1.97 m	1972
103898	58.600	Steel Waler Universal SRU U120, l = 2.22 m	2222
123812	63.000	Steel Waler Universal SRU U120, l = 2.37 m	2372
103892	65.600	Steel Waler Universal SRU U120, l = 2.47 m	2472
103929	72.000	Steel Waler Universal SRU U120, l = 2.72 m	2722
103903	81.000	Steel Waler Universal SRU U120, l = 2.97 m	2972
103906	92.600	Steel Waler Universal SRU U120, l = 3.47 m	3472
103915	106.000	Steel Waler Universal SRU U120, l = 3.97 m	3972
103918	119.000	Steel Waler Universal SRU U120, l = 4.47 m	4472
103922	135.000	Steel Waler Universal SRU U120, l = 4.97 m	4972
103925	146.000	Steel Waler Universal SRU U120, l = 5.47 m	5472
103928	159.000	Steel Waler Universal SRU U120, l = 5.97 m	5972

Universal Steel Waler Profile U120 used as waling for girder wall formwork and for diverse special applications. With adjustable spacers.

Note

Permissible load: see PERI Design Tables.

Technical Data

U120: $W_y = 121.4 \text{ cm}^3$, $I_y = 728 \text{ cm}^4$.

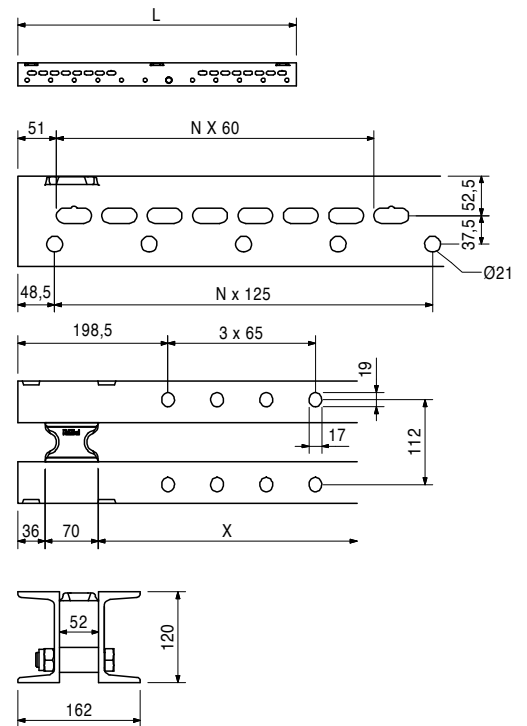
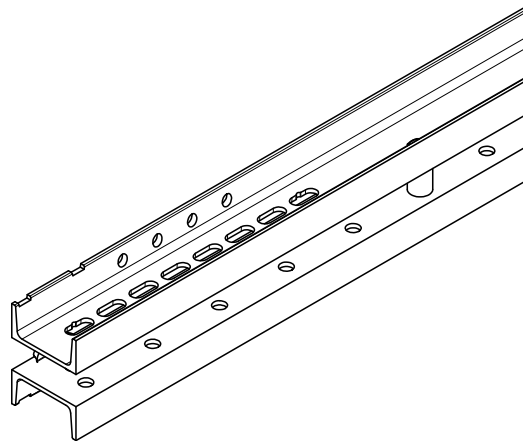

Item no.	Weight kg
104027	7.610

Extension VARIO 24 U120
For assembly on Steel Waler SRU.

Complete with
4 pc. 710252 Bolt ISO 4017 M16 x 50-8.8, galv.
4 pc. 104024 Nut ISO 7040 M16-8, galv.
4 pc. 710880 Washer DIN 434 18, galv.

Technical Data
U120: $W_y = 121.4 \text{ cm}^3$, $I_y = 728 \text{ cm}^4$.

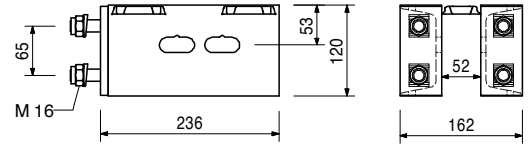
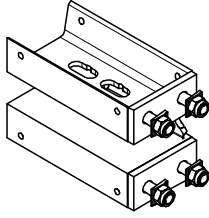

111035	12.000	Heavy Duty Spindles SLS
101773	15.300	Heavy Duty Spindle SLS 40/80
101774	18.300	Heavy Duty Spindle SLS 80/140
101776	24.900	Heavy Duty Spindle SLS 100/180
101777	32.300	Heavy Duty Spindle SLS 140/240
101778	38.500	Heavy Duty Spindle SLS 200/300
101779	38.500	Heavy Duty Spindle SLS 260/360
109726	44.800	Heavy Duty Spindle SLS 320/420
109785	51.000	Heavy Duty Spindle SLS 380/480

Used as adjustable spindle for truss beams made of Steel Walers SRU and Climbing Rails RCS.

A	min. L	max. L
344	400	800
746	800	1400
946	1000	1800
1346	1400	2400
1944	2000	3000
2544	2600	3600
3144	3200	4200
3744	3800	4800

Note
Permissible load see PERI Design Tables.

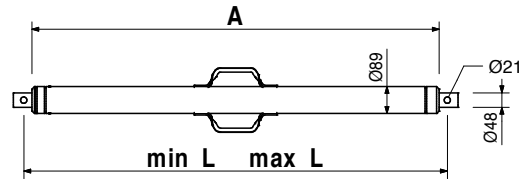
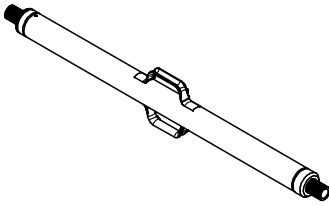

104031	0.462	Fitting Pin Ø 21 x 120
018060	0.014	Cotter Pin 4/1, galv.
110477	3.990	Spindle Adapter SLS/RCS

Accessories
Spindle Adapter SLS/RCS

110477	3.990	Spindle Adapter SLS/RCS
--------	-------	--------------------------------

For connecting the Heavy-Duty Spindle SLS to the Climbing Rail RCS.

Complete with
1 pc. 104031 Fitting Pin Ø 21 x 120
1 pc. 018060 Cotter Pin 4/1, galv.

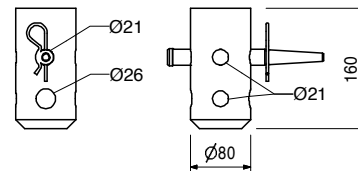
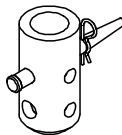

104031	0.462	Fitting Pin Ø 21 x 120
018060	0.014	Cotter Pin 4/1, galv.
111567	0.729	Fitting Pin Ø 26 x 120
022230	0.033	Cotter Pin 5/1, galv.

Accessories
Spindle Adapter SLS/RCS

Item no.	Weight kg
104031	0.462

Fitting Pin Ø 21 x 120
For different connections.

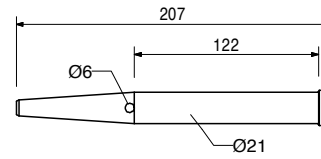
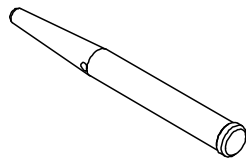

Accessories

018060	0.014
--------	-------

Cotter Pin 4/1, galv.

018060	0.014
--------	-------

Cotter Pin 4/1, galv.



			L
026415	3.550	Scaffold Tubes Steel Ø 48.3 x 3.2	
026417	0.000	Scaff. Tube Steel Ø 48.3 x 3.2, special length	
026411	3.550	Cutting Cost Scaffold Tube	
026412	7.100	Scaff. Tube Steel Ø 48.3 x 3.2, l = 1.0 m	1000
125976	8.900	Scaff. Tube Steel Ø 48.3 x 3.2, l = 2.0 m	2000
026413	10.650	Scaff. Tube Steel Ø 48.3 x 3.2, l = 2.5 m	2500
114287	12.500	Scaff. Tube Steel Ø 48.3 x 3.2, l = 3.0 m	3000
026414	14.200	Scaff. Tube Steel Ø 48.3 x 3.2, l = 3.5 m	3500
026419	17.750	Scaff. Tube Steel Ø 48.3 x 3.2, l = 4.0 m	4000
026418	21.600	Scaff. Tube Steel Ø 48.3 x 3.2, l = 5.0 m	5000
		Scaff. Tube Steel Ø 48.3 x 3.2, l = 6.0 m	6000

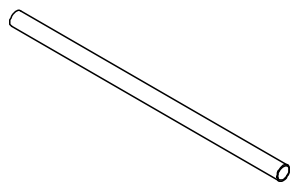

017010	1.400
--------	-------

Swivel Coupling DK 48/48, galv.
For Scaffold Tubes Ø 48 mm.

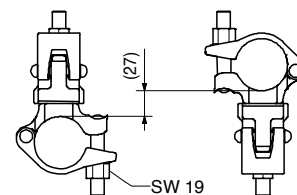
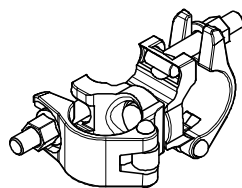

Item no.	Weight kg
017020	1.120

Standard Coupler NK 48/48, galv.
For Scaffold Tubes \varnothing 48 mm.

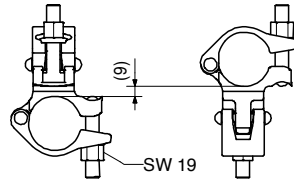
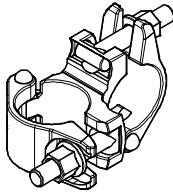

		Tie Rods DW 15
030030	1.440	Tie Rod DW 15, spec. length
030050	0.000	Cutting Cost Tie Rod DW 15, B 15
030005	0.720	Tie Rod DW 15, l = 0.50 m
030010	1.230	Tie Rod DW 15, l = 0.85 m
030480	1.440	Tie Rod DW 15, l = 1.00 m
030490	1.730	Tie Rod DW 15, l = 1.20 m
030170	2.160	Tie Rod DW 15, l = 1.50 m
030020	2.450	Tie Rod DW 15, l = 1.70 m
030180	2.880	Tie Rod DW 15, l = 2.00 m
030710	3.600	Tie Rod DW 15, l = 2.50 m
030720	4.320	Tie Rod DW 15, l = 3.00 m
030730	5.040	Tie Rod DW 15, l = 3.50 m
030160	8.640	Tie Rod DW 15, l = 6.00 m

Note
Non-weldable! Take official Approval into consideration!

Technical Data
Permissible tension force 90 kN.

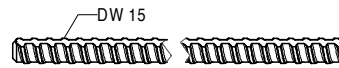
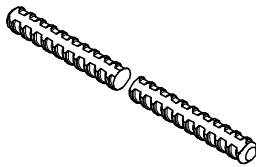

		Tie Rod B 15
030740	1.550	Tie Rod B 15, spec. length
030050	0.000	Cutting Cost Tie Rod DW 15, B 15
030150	0.420	Tie Rod B 15, l = 0.30 m

Note
Weldable! Take official Approval into consideration!

Technical Data
Permissible tension force 82 kN.

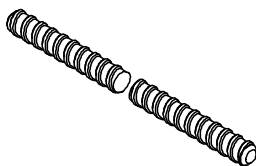

030130	0.318	Cam Nut DW 15, galv. For anchoring with Tie Rod DW 15 and B 15.
--------	-------	---

Technical Data
Permissible load 90 kN.

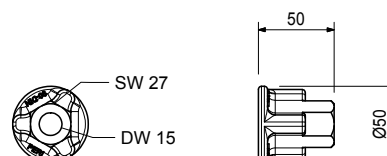
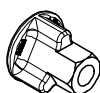

Item no.	Weight kg
030110	0.799

Wingnut Counterplate DW 15, galv.
For anchoring with Tie Rod DW 15 and B 15.

Technical Data
Permissible load 90 kN.

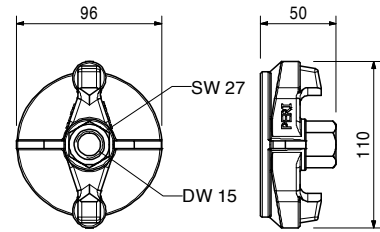

030100	0.439
--------	-------

Wingnut DW 15, galv.
For anchoring with Tie Rod DW 15 and B 15.

Technical Data
Permissible load 90 kN.

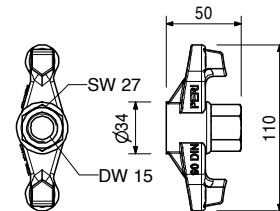

030370	1.660
--------	-------

Wingnut Pivot Plate DW 15, galv.
For anchoring with Tie Rod DW 15 and B 15. With pivoting captive nut. Maximum angle of tilting 8°.

Note
Wrench size SW 27.
Technical Data
Permissible load 90 kN.

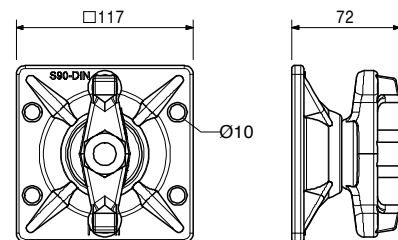
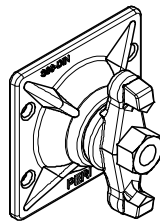

030070	0.222
--------	-------

Hex. Nut DW 15 SW 30/50, galv.
For anchoring with Tie Rod DW 15 and B 15.

Technical Data
Permissible load 90 kN.

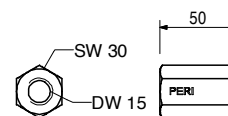

Item no.	Weight kg
030550	0.233

Hex. Nut DW 15 SW 30/50, weldable
For anchoring with Tie Rod DW 15 and B 15.

Note
Weldable!
Technical Data
Permissible load 90 kN.

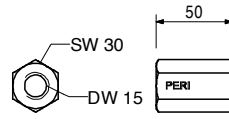

030090	0.402
--------	-------

Hex. Nut DW 15 SW 30/108, galv.
For coupling Tie Rod DW 15 and B 15.

Technical Data
Permissible load 90 kN.

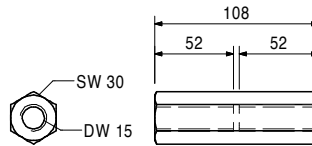
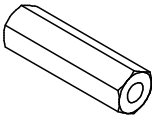

030840	0.515
--------	-------

Threaded Anchor Plate DW 15
For use with Tie Rod DW 15 or B 15. For anchoring in concrete.

Note
Lost anchor part.

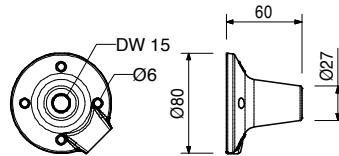
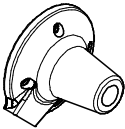

110797	2.790
--------	-------

Tension Rod 15 SRU, l = 1.50 m
Suitable for Strut SRU I = 1.65 - 2.40 m, item no. 110765 and the Spacer Tube DW 15-550 VARIOKIT.

Technical Data
Permissible load 85 kN.

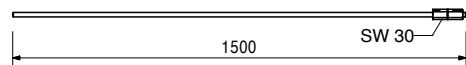
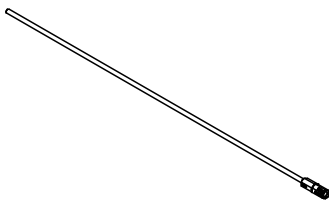

Item no.	Weight kg
115538	3.190

Tie Rod with Yoke VARIOKIT

For anchoring tensionloads of the consol brackets.

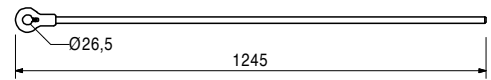
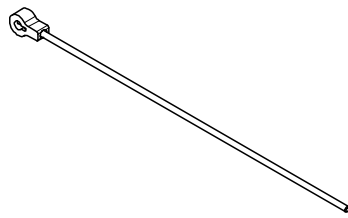

Accessories

111567	0.729
022230	0.033

Fitting Pin Ø 26 x 120

Cotter Pin 5/1, galv.

116532	1.890
--------	-------

Tie Yoke VARIOKIT Ø 22 / DW 15

For assembling in Steel Waler SRU.

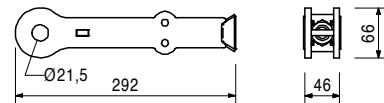
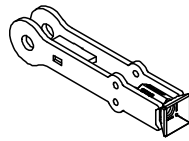

037150	0.641
--------	-------

Tie Yoke DW 15

For fixing SRZ Steel Walers to the strongback.

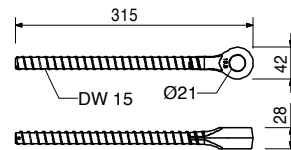

108795	0.450
--------	-------

Rock Anchor HB DW 15

For subsequent anchoring with DW 15 tie rods.
Diameter of drilled hole 36.5 - 38 mm.

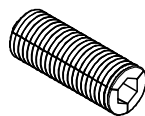

Note

Follow Instructions for Use!

Technical Data

Permissible load 90 kN.

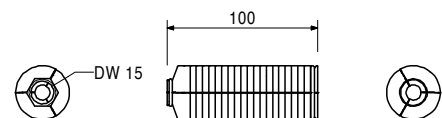

Item no.	Weight kg
031300	1.350

Weld on Anchor DW 15
For anchoring single-sided formwork.

Technical Data
Permissible tension force 90 kN.

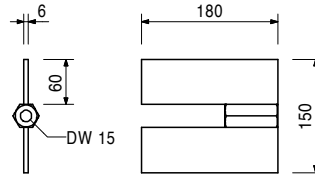
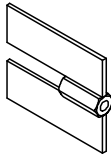

116807	1.820
--------	-------

Turnbuckle CB M20/DW 15
For tensioning of Tie Rod DW 15 to prevent tipping over due to wind loads. Connects Tie Rod DW 15 with Wall Bracing Shoe CB M24.

Complete with
1 pc. 711059 Turnbuckle for tension anchor CB
1 pc. 711060 Eye Bolt M20, left, galv.

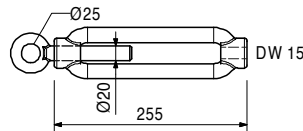
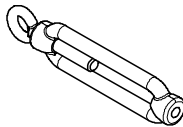

057083	3.820
--------	-------

Bracing DW 15 ACS
For bracing climbing scaffolds. For bracing large VARIO GT 24 Elements.

Complete with
2 pc. 024910 Bolt ISO 4014 M20 x 100-8.8, galv.
2 pc. 710334 Nut ISO 4032 M20-8, galv.

Note
Tie Rod DW 15 must be ordered separately.

Technical Data
Permissible tension load 35 kN.

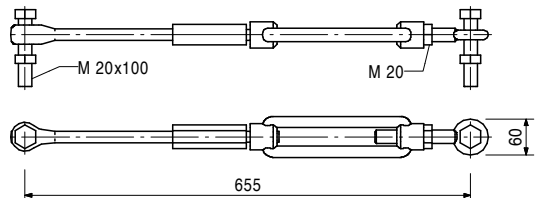
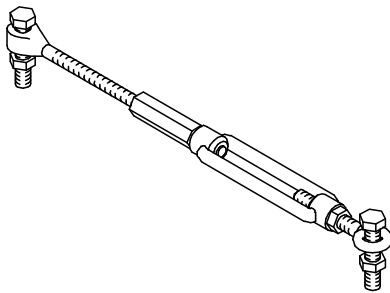

Accessories

030030	1.440
030050	0.000

Tie Rod DW 15, spec. length
Cutting Cost Tie Rod DW 15, B 15

Item no.	Weight kg
115375	6.100

Articulated Spanner RCS DW 15

For tensioning and as an articulated connection to the Climbing Rail RCS, Steel Waler SRU or Bracing Shoe RCS for bracing with DW 15.

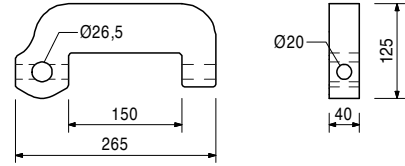
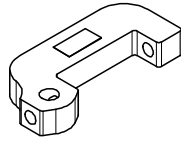

Accessories

104031	0.462	Fitting Pin Ø 21 x 120
018060	0.014	Cotter Pin 4/1, galv.
111567	0.729	Fitting Pin Ø 26 x 120
022230	0.033	Cotter Pin 5/1, galv.
030070	0.222	Hex. Nut DW 15 SW 30/50, galv.
030030	1.440	Tie Rod DW 15, spec. length

115378	1.080
--------	-------

Eye Nut RCS DW 15

As an articulated connection to the Climbing Rail RCS, Steel Waler SRU for bracing with DW 15.

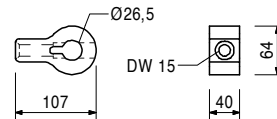

Accessories

104031	0.462	Fitting Pin Ø 21 x 120
018060	0.014	Cotter Pin 4/1, galv.
111567	0.729	Fitting Pin Ø 26 x 120
022230	0.033	Cotter Pin 5/1, galv.

123534	5.910
--------	-------

Brace Connector RCS DW 15/M20

For mounting diagonal bracing with Tie Rod DW 15 and a compression strut to the Climbing Rail RCS.

Complete with

2 pc. 710894 Pin Ø 25 x 180, geomet.
4 pc. 018060 Cotter Pin 4/1, galv.

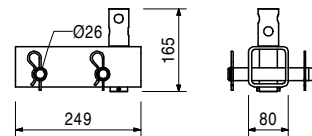
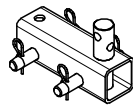

117766	4.450
--------	-------

Bracing Connector SRU/DW 15

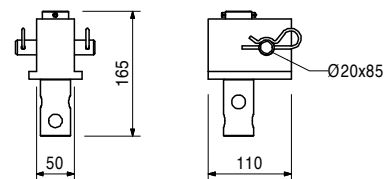
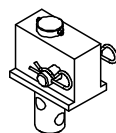

Item no.	Weight kg
031070	1.260

Tie Rod Wrench 15, galv.
For easy handling of Tie Rod DW 15.

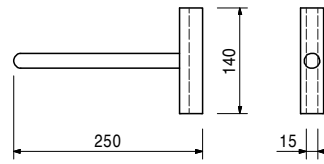
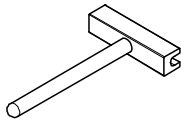

108129	3.480
--------	-------

Tie Rod Spanner DW 15
For Wingnut Counterplate DW 15, Wingnut Pivot Plate DW 15 and Wingnut DW 15.

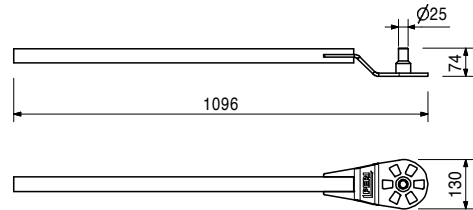
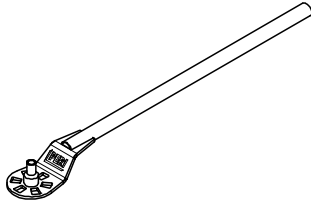

030700	2.560
030800	0.000
030640	1.280
030641	2.560
030680	15.400

Tie Rods DW 20
Tie Rod DW 20, spec. length
Cutting Cost Tie Rod DW 20/B 20
Tie Rod DW 20, l = 0.50 m
Tie Rod DW 20, l = 1.00 m
Tie Rod DW 20, l = 6.00 m

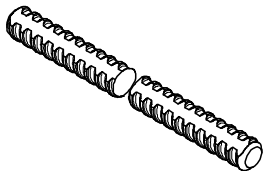

Note
Non-weldable! Take official Approval into consideration!

Technical Data
Permissible tension force 150 kN.

030745	2.600
030800	0.000

Tie Rod B 20
Tie Rod B 20, spec. length
Cutting Cost Tie Rod DW 20/B 20

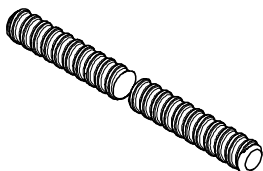

Note
Weldable! Take official Approval into consideration!

Technical Data
Permissible tension force 150 kN.

Item no.	Weight kg
030990	0.786

Wingnut DW 20, galv.
For anchoring with Tie Rod DW 20 and B 20.

Technical Data
Permissible load 150 kN.

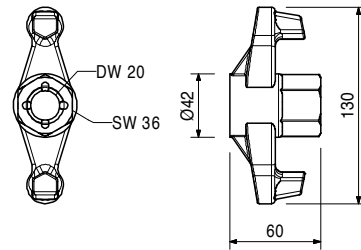

127587	3.210
--------	-------

Wingnut Pivot Plate DW 20, galv.
For anchoring with Tie Rod DW 20. With pivoting captive nut. Maximum angle of tilting +/- 8°.

Technical Data
Permissible load 120 kN.

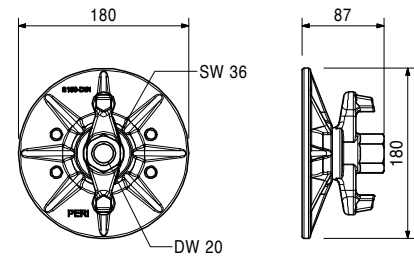
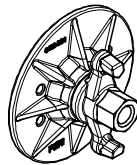

030580	0.371
--------	-------

Hex. Nut DW 20 SW 36/60, weldable
For anchoring with Tie Rod DW 20 and B 20.

Note
Weldable!
Technical Data
Permissible load 150 kN.

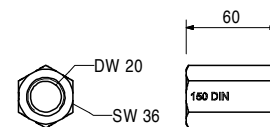
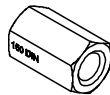

030590	0.685
--------	-------

Hex. Nut DW 20 SW 36/110, weldable
For coupling Tie Rod DW 20 and B 20.

Note
Weldable!
Technical Data
Permissible load 150 kN.

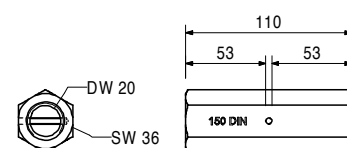
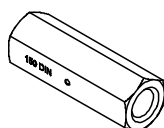

Item no.	Weight kg
----------	-----------

114082	2.860
--------	-------

Counterplate RCS DW 20

Counterplate with centring for anchoring through the Climbing Rail RCS.

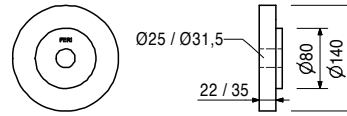

030860	0.792
--------	-------

0.792

Threaded Anchor Plate DW 20

For use with Tie Rod DW 20, B 20 or Screw-On Cone-2 M24/DW 20. For anchoring in concrete.

Note
Lost anchor part.

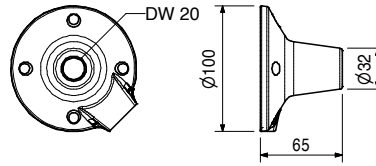
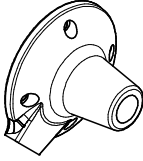

031050	1.780
--------	-------

1.780

Tie Rod Wrench 20, galv.

For easy handling of Tie Rod DW 20.

